

350-123

Figure 7-6. Display Assy, A1A2

NOTE

To find index numbers for circuit board components, use the reference designator index at the end of this chapter. The complete reference designator for a circuit board component consists of "1," followed by the assembly designator (A1, A2, etc.), then the reference designator on the illustration. For example, the complete reference designator for R25 on the Front Panel PWB Assy is 1A1A1 R25.

Figure & Index Number	Part Number	FSCM	Description							Units Per Assy	Usable On Code	SMR Code
			1	2	3	4	5	6	7			
7-6 -	10085-2110	14304	DISPLAY ASSY,A1A2							1		PAODD
- 1	0736-7232	32890	. LED							2		PADZZ
- 2	429E3F99KGZ	09214	. DISPLAY							1		PADZZ
- 3	10085-2120	14304	. CIRCUIT CARD ASSY							1		PAOLD
- 4	MD015E104MAA	04222	. CAPACITOR,FXD,CER							5		PADZZ
- 5	65516-110	22526	. CONTACT ASSY							2		PADZZ
- 6	HLCD0438AY	61587	. MICROCIRCUIT							5		PADZZ
- 7	10085-2129	14304	. CIRCUIT CARD							1		XA
- 8	10085-2112	14304	. BRACKET,RETAINER							2		XB
- 9	10085-5136	14304	. CONNECTOR,RCPT,ELEC							4		PADZZ

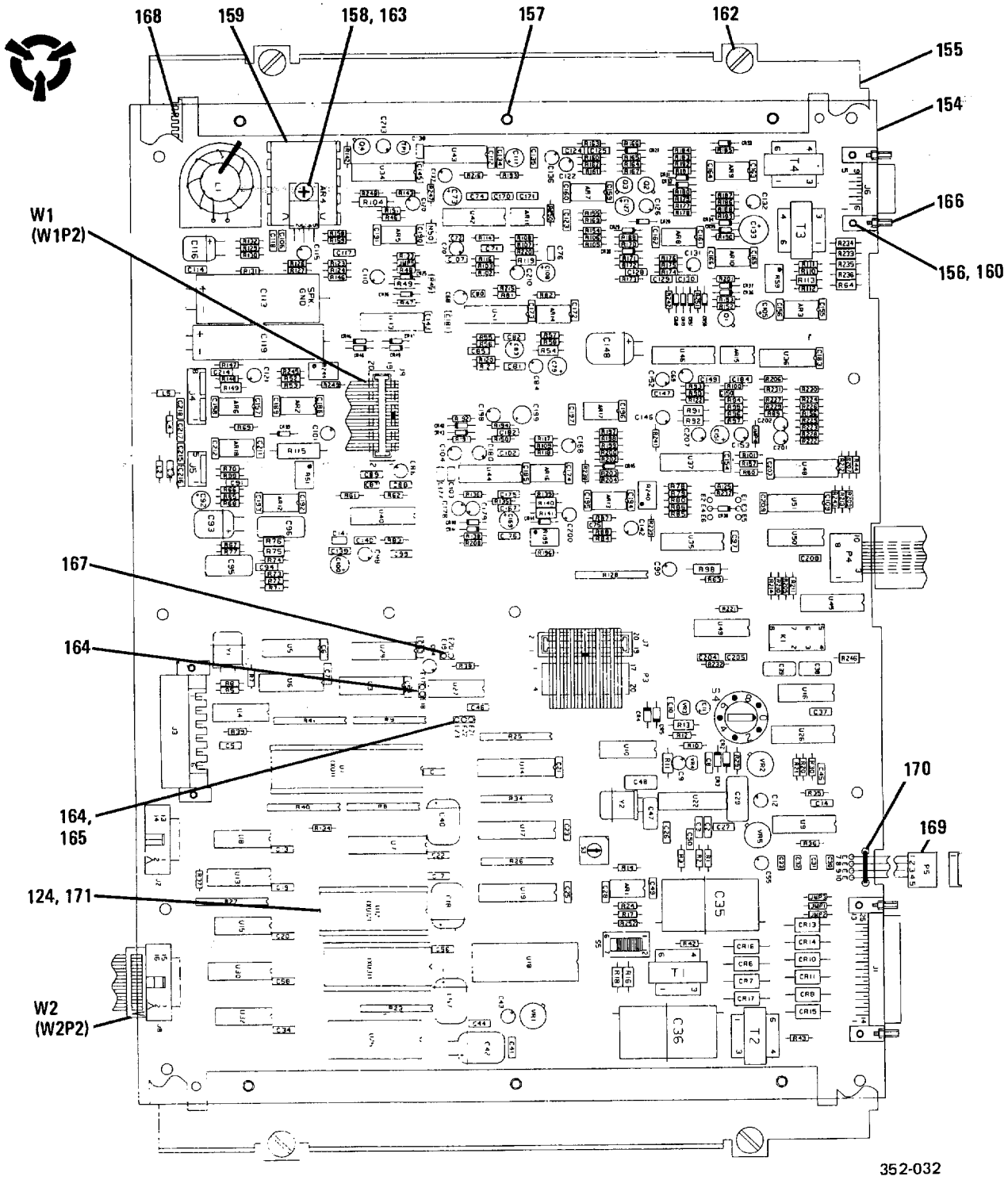

Figure 7-7. Audio /Microprocessor PwB Assy, A2

NOTE

To find index numbers for circuit board components, use the reference designator index at the end of this chapter. The complete reference designator for a circuit board component consists of "1," followed by the assembly designator (A1, A2, etc.), then the reference designator on the illustration. For example, the complete reference designator for R25 on the Front Panel PWB Assy is 1A1A1 R25.

Figure & Index Number	Part Number	FSCM	Description							Units Per Assy	Usable On Code	SMR Code
			1	2	3	4	5	6	7			
7-7 -	10088-5000	14304	CIRCUIT CARD ASSY, A2							1		PAODD
- 1	MC1558U	04713	. MICROCIRCUIT							15		PADZZ
- 2	TDA2002H	04713	. MICROCIRCUIT							1		PADZZ
- 3	TLO71MJG	01295	. MICROCIRCUIT							2		PADZZ
- 4	CK06BX104K	81349	. CAPACITOR, FXD, CER							83		PADZZ
- 5	T392B335M025AS	31433	. CAP, FXD, ELCTLT							27		PADZZ
- 6	T392F157M010AS	31433	. CAP, FXD, ELCTLT							4		PADZZ
- 7	CK06BX103K	81349	. CAPACITOR, FXD, CER							7		PADZZ
- 8	CM06FD152J03	81349	. CAPACITOR, FXD, MICA							1		PADZZ
- 9	CK05BX470K	81349	. CAPACITGR, FXD, CER							5		PADZZ
- 10	7FR2052B	54904	. CAPACITOR, FXD, MYLAR							2		PADZZ
- 11	CM05FD201G03	81349	. CAPACITOR, FXD, MICA							2		PADZZ
- 12	T392B155M035AS	31433	. CAP, FXD, ELCTLT							9		PADZZ
- 13	CM05ED220J03	81349	. CAPACITOR, FXD, MICA							2		PADZZ
- 14	M39014/02-1356	81349	. CAPACITOR FXD CER							10		PADZZ
- 15	M39014/01-1345	81349	. CAPACITOR, FXD, CER							7		PADZZ
- 16	T392C106M025AS	31433	. CAP, FXD, ELCTLT							14		PADZZ
- 17	M39014/01-1341	81349	. CAPACITOR, FXD, CER							1		PADZZ
- 18	CK05BX221K	81349	. CAPACITOR, FXD, CER							7		PADZZ
- 19	CK06BX224K	81349	. CAPACITOR FXD CER							10		PADZZ
- 20	CK06BX474K	81349	. CAPACITOR, FXD, CER							9		PADZZ
- 21	M39014/02-1338	81349	. CAPACITOR, FXD, CER							5		PADZZ
- 22	CMR06F362G0DR	81349	. CAPACITOR, FXD, MICA							1		PADZZ
- 23	CMR06F182G0DR	81349	. CAPACITOR, FXD, MICA							1		PADZZ
- 24	672D128H025FV5J	56289	. CAP, FXD, ELCTLT							1		PADZZ
- 25	T392F157M016AS	31433	. CAP, FXD, ELCTLT							1		PADZZ
- 26	M39014/02-1354	81349	. CAPACITOR, FXD, CER							1		PADZZ
- 27	672D477H025DS5J	56289	. CAP, FXD, ELCTLT							1		PADZZ
- 28	M39014/02-1342	81349	. CAPACITOR, FXD, CER							1		PADZZ
- 29	CX02N156K	81349	. CAPACITOR, FXD, CER							1		PADZZ
- 30	T392F686M025AS	31433	. CAP, FXD, ELCTLT							1		PADZZ
- 31	M39014/01-1330	81349	. CAPACITOR, FXD, CER							1		PADZZ
- 32	M39014/02-1326	81349	. CAPACITOR FXD CERM							1		PADZZ
- 33	JAN1N3611	81349	. SEMICOND DEVICE, DIO							4		PADZZ
- 34	JAN1N4454	81349	. SEMICOND DEVICE, DIO							26		PADZZ
- 35	JAN1N750A	81349	. SEMICOND DEVICE, DIO							2		PADZZ
- 36	117-DBE-25PA	02660	. CONNECTOR, RCPT, ELEC							1		PADZZ
- 37	609-1407	59730	. CONNECTOR, RCPT, ELEC							1		PADZZ
- 38	207378-3	00779	. CONNECTOR, RCPT, ELEC							1		PADZZ
- 39	22-11-2082	27264	. CONNECTOR, RCPT, ELEC							1		PADZZ
- 40	22-11-2052	27264	. CONNECTOR, RCPT, ELEC							1		PADZZ
- 41	10088-7021	14304	. CONNECTOR, RCPT, ELEC							1		PADZZ
- 42	1251-6823	28480	. CONNECTOR, RCPT, ELEC							2		PADZZ
- 43	609-1607	15912	. CONNECTOR, RCPT, ELEC							1		PADZZ
- 44	609-2027	15912	. CONNECTOR, RCPT, ELEC							2		PADZZ

Figure & Index Number	Part Number	FSCM	Description							Units Per Assy	Usable On Code	SMR Code
			1	2	3	4	5	6	7			
- 45	MP-1142	14304	4		PADZZ
- 46	K-0118	14304	1		PADZZ
- 47	10085-5212	14304	1		PADZZ
- 48	MS75085-7	96906	4		PADZZ
- 49	10085-0337	14304	1		PADZZ
- 50	22-01-3057	27264	1		PADZZ
- 51	JAN2N2222A	81349	1		PADZZ
- 52	JAN2N2907A	81349	1		PADZZ
- 53	JAN2N4091	81349	2		PADZZ
- 54	CF07-103J	78488	53		PADZZ
- 55	CF07-223J	78488	6		PADZZ
- 56	CF07-681J	78488	3		PADZZ
- 57	4310R-101-103	32997	10		PADZZ
- 58	RN55D6040F	81349	8		PADZZ
- 59	CF07-203J	78488	2		PADZZ
- 60	CF07-102J	78488	22		PADZZ
- 61	CF07-473J	78488	5		PADZZ
- 62	CF07-475J	78488	1		PADZZ
- 63	CF07-151J	78488	2		PADZZ
- 64	CF07-104J	78488	24		PADZZ
- 65	CF07-472J	78488	6		PADZZ
- 66	CF07-123J	78488	1		PADZZ
- 67	RNC55K1002FS	81349	1		PADZZ
- 68	RNC55K1332FS	81349	1		PADZZ
- 69	RJR24FW104P	81349	3		PADZZ
- 70	CF07-333J	78488	9		PADZZ
- 71	CF07-224J	78488	2		PADZZ
- 72	3299W-1-104	57921	3		PADZZ
- 73	CF07-471J	78488	2		PADZZ
- 74	CF07-563J	78488	2		PADZZ
- 75	RNC55K5112FS	81349	2		PADZZ
- 76	RN55D5112F	81349	2		PADZZ
- 77	CF07-273J	78488	4		PADZZ
- 78	CF07-823J	78488	5		PADZZ
- 79	CF07-393J	78488	7		PADZZ
- 80	CF07-244J	78488	1		PADZZ
- 81	RNC55K4321FS	81349	1		PADZZ
- 82	RNC55K2004FS	81349	1		PADZZ
- 83	CF07-4R7J	78488	1		PADZZ
- 84	CF07-153J	78488	3		PADZZ
- 85	CF07-101J	78488	2		PADZZ
- 86	CF07-623J	78488	1		PADZZ
- 87	RCR32G271JS	81349	1		PADZZ
- 88	CF07-183J	78488	1		PADZZ
- 89	CF07-392J	78488	1		PADZZ
- 90	CF07-822J	78488	1		PADZZ
- 91	CF07-272J	78488	1		PADZZ
- 92	CF07-2R7J	78488	3		PADZZ
- 93	CF07-821J	78488	1		PADZZ
- 94	CF07-105J	78488	3		PADZZ
- 95	RNC55K2432FS	81349	1		PADZZ

Figure & Index Number	Part Number	FSCM	Description							Units Per Assy	Usable On Code	SMR Code
			1	2	3	4	5	6	7			
- 96	RNC55K3010FS	81349	.	RESISTOR, FXD, FILM						1		PADZZ
- 97	CF07-184J	78488	.	RESISTOR, FXD, COMP						2		PADZZ
- 98	CF07-222J	78488	.	RESISTOR, FXD, COMP						7		PADZZ
- 99	CF07-124J	78488	.	RESISTOR, FXD, COMP						1		PADZZ
-100	CF07-334J	78488	.	RESISTOR, FXD, COMP						3		PADZZ
-101	CF07-561J	78488	.	RESISTOR, FXD, COMP						2		PADZZ
-102	CF07-270J	78488	.	RESISTOR, FXD, COMP						1		PADZZ
-103	CF07-152J	78488	.	RESISTOR, FXD, COMP						1		PADZZ
-104	3299W-1-504	57921	.	RESISTOR, VARIABLE						2		PADZZ
-105	CF07-122J	78488	.	RESISTOR, FXD, COMP						1		PADZZ
-106	RNC55K1151FS	81349	.	RESISTOR, FXD, FILM						2		PADZZ
-107	RNC55K4320FS	81349	.	RESISTOR, FXD, FILM						2		PADZZ
-108	RN55D4320F	81349	.	RESISTOR, FXD, FILM						2		PADZZ
-109	RN55D1151F	81349	.	RESISTOR, FXD, FILM						2		PADZZ
-110	DRD-10C	95146	.	SWITCH, ROTARY						1		PADZZ
-111	1-435097-1	00779	.	SWITCH, ROTARY						1		PADZZ
-112	MSS-4200	95146	.	SWITCH, TOGGLE						1		PADZZ
-113	TY-304P	04386	.	TRANSFORMER, RF						4		PADZZ
-114	105-0858-001	74970	.	JACK, TIP						1		PADZZ
-115	TD8031AH	34649	.	MICROCIRCUIT						1		PADZZ
-116	SN54LS165J	01295	.	MICROCIRCUIT						1		PADZZ
-117	SN54LS04J	01295	.	MICROCIRCUIT						1		PADZZ
-118	SN54LS74AJ	01295	.	MICROCIRCUIT						1		PADZZ
-119	7705801EB	14933	.	MICROCIRCUIT						2		PADZZ
-120	SN54LS373J	01295	.	MICROCIRCUIT						3		PADZZ
-121	SN54LS08J	01295	.	MICROCIRCUIT						2		PADZZ
-122	AM26LS30DM	34335	.	MICROCIRCUIT						1		PADZZ
-123	DS1488J	27014	.	MICROCIRCUIT						1		PADZZ
-124	10088-9540	14304	.	EPRM, PROGRAMMED						1		PADZZ
-125	SN54LS138J	01295	.	MICROCIRCUIT						2		PADZZ
-126	SN54LS02J	01295	.	MICROCIRCUIT						2		PADZZ
-127	DS1489AJ	27014	.	MICROCIRCUIT						1		PADZZ
-128	ADC0808CCJ	27014	.	MICROCIRCUIT						1		PADZZ
-129	SN54LS245J	01295	.	MICROCIRCUIT						1		PADZZ
-130	TMS99532NS	01295	.	MICROCIRCUIT						1		PADZZ
-131	8103908JB	14933	.	MICROCIRCUIT						1		PADZZ
-132	AM26LS33DM	34335	.	MICROCIRCUIT						1		PADZZ
-133	CD4011BD/3	02735	.	MICROCIRCUIT						1		PADZZ
-134	CD4040BF	02735	.	MICROCIRCUIT						2		PADZZ
-135	CD4051BD/3	02735	.	MICROCIRCUIT						1		PADZZ
-136	351-8434-010	13499	.	MICROCIRCUIT						3		PADZZ
-137	CD4053BF	02735	.	MICROCIRCUIT						3		PADZZ
-138	M38510/11201BCB	81349	.	MICROCIRCUIT						1		PADZZ
-139	SA571F	18324	.	MICROCIRCUIT						5		PADZZ
-140	ULQ-2003R	56289	.	MICROCIRCUIT						1		PADZZ
-141	SA572F	18324	.	MICROCIRCUIT						1		PADZZ
-142	CD4049BF	02735	.	MICROCIRCUIT						1		PADZZ
-143	M38510/17204BCB	81349	.	MICROCIRCUIT						1		PADZZ
-144	M38510/30501BCB	81349	.	MICROCIRCUIT						1		PADZZ
-145	VA78M05HM	07263	.	MICROCIRCUIT						1		PADZZ
-146	LM120H-5.0	27014	.	MICROCIRCUIT						1		PADZZ

Figure & Index Number	Part Number	FSCM	Description							Units Per Assy	Usable On Code	SMR Code
			1	2	3	4	5	6	7			
-147	UA78M12HM	07263	.							1		PADZZ
-148	10088-0304	14304	.							1		PAOZZ
-149	10088-0305	14304	.							1		PAOZZ
-150	540-AG11D	91506	.							1		PADZZ
-151	528-AG11D	91506	.							1		PADZZ
-152	MP150	22903	.							1		PADZZ
-153	FOX0432	61429	.							1		PADZZ
-154	10088-5009	14304	.							1		XA
-155	10088-5015	14304	.							1		XB
-156	M24243/1-B304	81349	.							6		PADZZ
-157	M24243/1-B402	81349	.							16		PADZZ
-158	H-6768	14304	.							1		XB
-159	610PB	13103	.							1		XB
-160	5710-8-20	86928	.							6		PADZZ
-161	MS15795-806	96906	.							1		PADZZ
-162	82-32-101-20	94222	.							4		PAOZZ
-163	MS51957-28	96906	.							1		PAOZZ
-164	65474-001	22526	.							2		PADZZ
-165	65499-103	22526	.							1		PADZZ
-166	205817-1	00779	.							2		PADZZ
-167	65499-102	22526	.							2		PADZZ
-168	MS21266-1N	96906	.							7		PADZZ
-169	08-56-0110	27264	.							4		PADZZ
-170	MS3367-4-9	96906	.							3		PADZZ
-171	TD271-28-4	34649	.							1		PADZZ

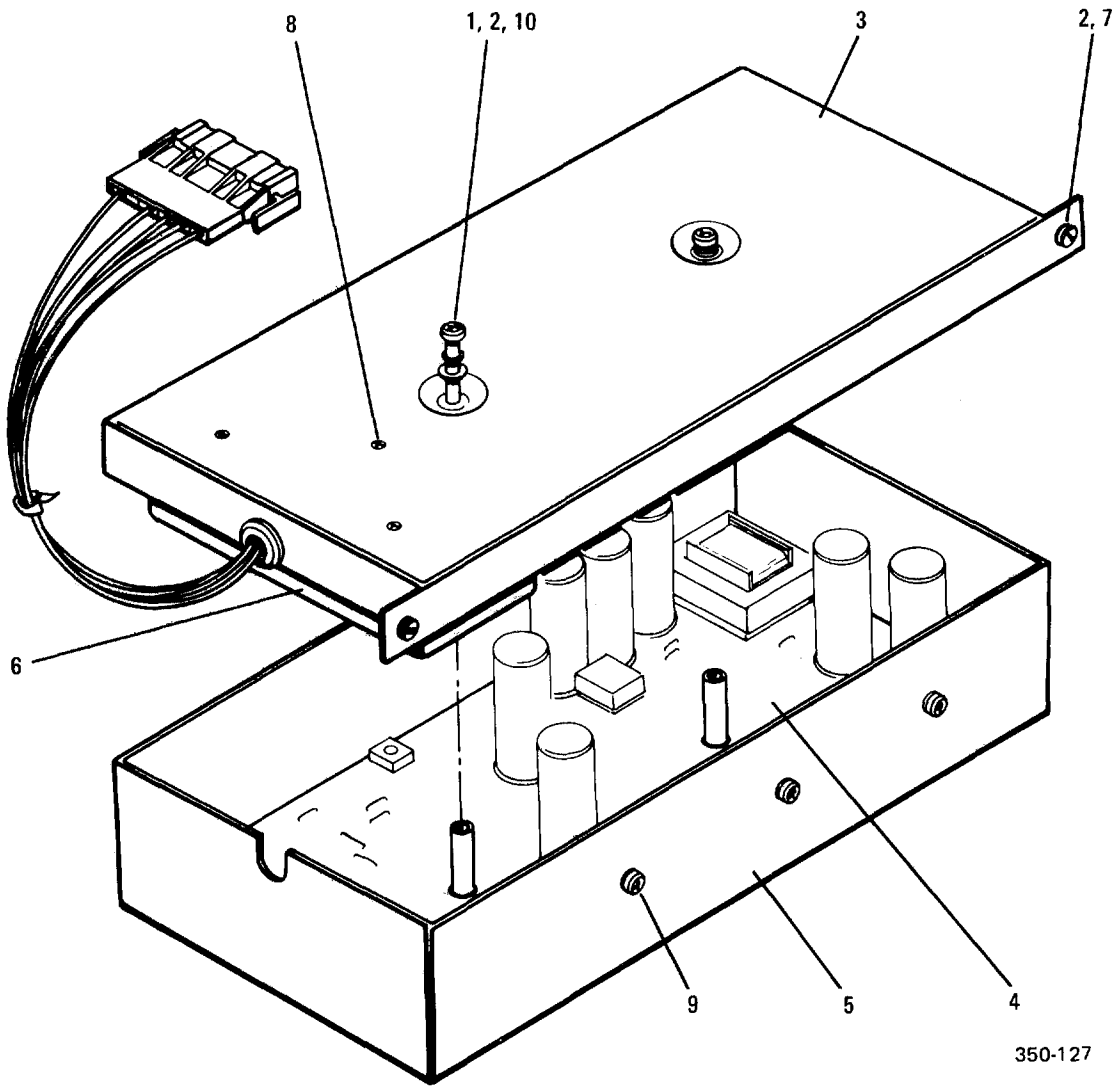

Figure 7-8. Multivoltage Supply Assy, A3

Figure & Index Number	Part Number	FSCM	Description 1 2 3 4 5 6 7	Units	Usable	SMR Code
				Per Assy	On Code	
7-8 -	10085-1240	14304	MULTIVOLT SPLY ASSY, A3	1		PAOLD
- 1	MS15795-805	96906	. WASHER, FLAT (AP)	2		PADZZ
- 2	MS35338-136	96906	. WASHER, SPLIT (AP)	4		PADZZ
- 3	10085-1209	14304	. COVER	1		XB
- 4	10085-1260	14304	. CIRCUIT CARD ASSY	1		XA
- 5	10085-1247	14304	. CASE	1		XB
- 6	10085-1230	14304	. FILTER ASSY, RF	1		PADZZ
- 7	6232-SS-0632	06540	. SCREW EXT RELIEVED	2		PAOZZ
- 8	MS24693-C16	96906	. SCREW, MACHINE (AP)	3		PAOZZ
- 9	MS51957-28	96906	. SCREW, MACHINE (AP)	3		PADZZ
- 10	10085-5131	14304	. SCREW, MACHINE (AP)	2		PADZZ

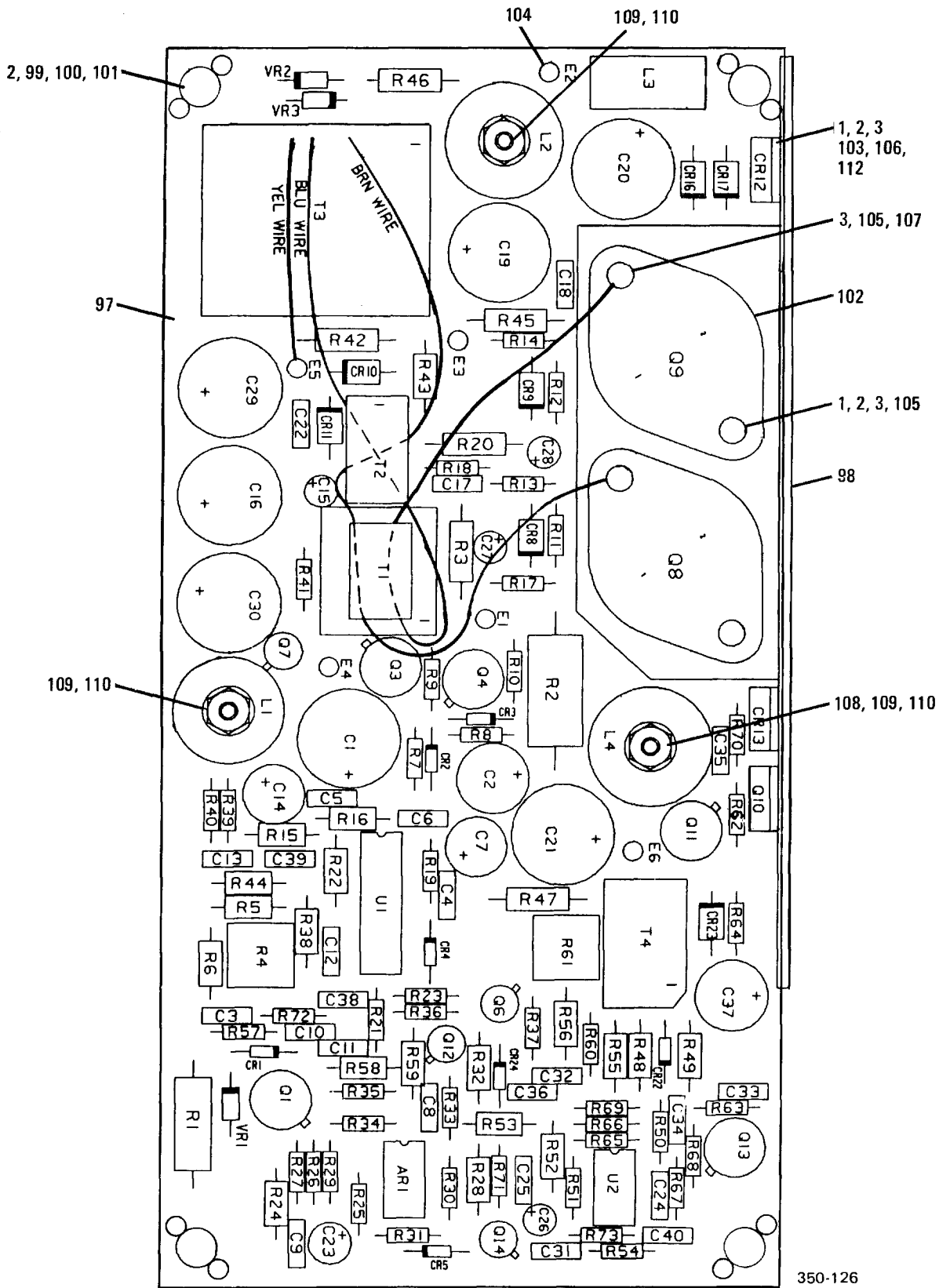

Figure 7-9. Multivoltage Supply PWB Assy, A3A1

NOTE

To find index numbers for circuit board components, use the reference designator index at the end of this chapter. The complete reference designator for a circuit board component consists of "1," followed by the assembly designator (A1, A2, etc.), then the reference designator on the illustration. For example, the complete reference designator for R25 on the Front Panel PWB Assy is 1A1A1 R25.

Figure & Index Number	Part Number	FSCM	Description							Units Per Assy	Usable On Code	SMR Code
			1	2	3	4	5	6	7			
7-9 -	10085-1260	14304	CIRCUIT CARD ASSY, A3A1							1		XA
- 1	MS15795-803	96906	. WASHER, FLAT (AP)							5		PADZZ
- 2	MS35338-135	96906	. WASHER, SPLIT (AP)							9		PADZZ
- 3	MS35649-244	96906	. NUT, PLAIN, HEX (AP)							7		PADZZ
- 4	MC1558U	04713	. MICROCIRCUIT							1		PADZZ
- 5	672D337H040ET5	56289	. CAP, FXD, ELCTLT							6		PADZZ
- 6	801591-31	96214	. CAP, FXD, ELCTLT							1		PADZZ
- 7	M39014/02-1344	81349	. CAPACITOR, FXD, CER							1		PADZZ
- 8	CKO6BX104K	81349	. CAPACITOR, FXD, CER							6		PADZZ
- 9	O180-2827	28480	. CAP, FXD, ELCTLT							2		PADZZ
- 10	CKO6BX103K	81349	. CAPACITOR, FXD, CER							4		PADZZ
- 11	CKO5BX102K	81349	. CAPACITOR, FXD, CER							3		PADZZ
- 12	M39014/02-1340	81349	. CAPACITOR, FXD, CER							1		PADZZ
- 13	CKO6BX474K	81349	. CAPACITOR, FXD, CER							4		PADZZ
- 14	T392D226M025AS	31433	. CAP, FXD, ELCTLT							1		PADZZ
- 15	T392B335M025AS	31433	. CAP, FXD, ELCTLT							2		PADZZ
- 16	672D337H040ET50	56289	. CAP, FXD, ELCTLT							6		PADZZ
- 17	672D108H015ET5C	56289	. CAP, FXD, ELCTLT							1		PADZZ
- 18	M39014/02-1332	81349	. CAPACITOR, FXD, CER							1		PADZZ
- 19	T392C106M025AS	31433	. CAP, FXD, ELCTLT							1		PADZZ
- 20	T392B155M035AS	31433	. CAP, FXD, ELCTLT							2		PADZZ
- 21	CKO6BX223K	81349	. CAPACITOR, FXD, CER							1		PADZZ
- 22	672D476H040CD5C	56289	. CAP, FXD, ELCTLT							2		PADZZ
- 23	CKO6BX332K	81349	. CAPACITOR, FXD, CER							1		PADZZ
- 24	CKO6BX273K	81349	. CAPACITOR, FXD, CER							1		PADZZ
- 25	M39014/02-1335	81349	. CAPACITOR, FXD, CER							1		PADZZ
- 26	JAN1N3611	81349	. SEMICOND DEVICE, DIO							1		PADZZ
- 27	JAN1N4454	81349	. SEMICOND DEVICE, DIO							6		PADZZ
- 28	JAN1N5417	81349	. SEMICOND DEVICE, DIO							7		PADZZ
- 29	RUR-D820	18722	. SEMICOND DEVICE, DIO							1		PADZZ
- 30	VHE1402	27777	. SEMICOND DEVICE, DIO							1		PADZZ
- 31	L13-0002-470	14304	. COIL, RF							1		PADZZ
- 32	L13-0002-331	14304	. COIL, RF							1		PADZZ
- 33	10085-1228	14304	. COIL, RF							1		PADZZ
- 34	10085-1268	14304	. COIL, RF							1		PADZZ
- 35	JAN2N3439	81349	. TRANSISTOR							2		PADZZ
- 36	JAN2N2219A	81349	. TRANSISTOR							2		PADZZ
- 37	JAN2N2222A	81349	. TRANSISTOR							2		PADZZ
- 38	JAN2N6341	81349	. TRANSISTOR							2		PADZZ
- 39	JAN2N6338	81349	. TRANSISTOR							2		PADZZ
- 40	151-0625-00	80009	. TRANSISTOR							1		PADZZ
- 41	2N4236	80131	. TRANSISTOR							1		PADZZ
- 42	JAN2N2907A	81349	. TRANSISTOR							2		PADZZ
- 43	RCR32G102JS	81349	. RESISTOR, FXD, COMP							1		PADZZ
- 44	RCR42G221JS	81349	. RESISTOR, FXD, COMP							1		PADZZ

Figure & Index Number	Part Number	FSCM	Description							Units Per Assy	Usable On Code	SMR Code
			1	2	3	4	5	6	7			
- 45	ERD50TJ100	54473	.	RESISTOR	,FXD	,COMP				2		PADZZ
- 46	72PM2K	73138	.	RESISTOR	,VARIABLE					1		PADZZ
- 47	RNC55K1152FS	81349	.	RESISTOR	,FXD	,FILM				1		PADZZ
- 48	RN55K2491FS	81349	.	RESISTOR	,FXD	,FILM				1		PADZZ
- 49	CF07-182J	78488	.	RESISTOR	,FXD	,COMP				2		PADZZ
- 50	CF07-471J	78488	.	RESISTOR	,FXD	,COMP				4		PADZZ
- 51	CF07-220J	78488	.	RESISTOR	,FXD	,XOMP				4		PADZZ
- 52	CF07-6R8J	78488	.	RESISTOR	,FXD	,COMP				2		PADZZ
- 53	RN55D4991F	81349	.	RESISTOR	,FXD	,FILM				2		PADZZ
- 54	CF07-2R7J	78488	.	RESISTOR	,FXD	,COMP				2		PADZZ
- 55	CF07-104J	78488	.	RESISTOR	,FXD	,COMP				2		PADZZ
- 56	CF07-333J	78488	.	RESISTOR	,FXD	,COMP				1		PADZZ
- 57	RN55D2211F	81349	.	RESISTOR	,FXD	,FILM				4		PADZZ
- 58	CF07-272J	78488	.	RESISTOR	,FXD	,COMP				2		PADZZ
- 59	RNC55K1102FS	81349	.	RESISTOR	,FXD	,FILM				1		PADZZ
- 60	CF07-103J	78488	.	RESISTOR	,FXD	,COMP				4		PADZZ
- 61	RN55D6811F	81349	.	RESISTOR	,FXD	,FILM				3		PADZZ
- 62	RN55D1003F	81349	.	RESISTOR	,FXD	,FILM				1		PADZZ
- 63	RNC55K8061FS	81349	.	RESISTOR	,FXD	,FILM				1		PADZZ
- 64	RNC55K2003FS	81349	.	RESISTOR	,FXD	,FILM				1		PADZZ
- 65	RN55D3321F	81349	.	RESISTOR	,FXD	,FILM				1		PADZZ
- 66	CF07-681J	78488	.	RESISTOR	,FXD	,COMP				1		PADZZ
- 67	CF07-102J	78488	.	RESISTOR	,FXD	,COMP				2		PADZZ
- 68	CF07-100J	78488	.	RESISTOR	,FXD	,COMP				3		PADZZ
- 69	RN55D1000F	81349	.	RESISTOR	,FXD	,FILM				1		PADZZ
- 70	CF07-101J	78488	.	RESISTOR	,FXD	,COMP				4		PADZZ
- 71	RNC60K23R7FS	81349	.	RESISTOR	,FXD	,FILM				1		PADZZ
- 72	RNC55K2150FS	81349	.	RESISTOR	,FXD	,FILM				1		PADZZ
- 73	RN55D4750F	81349	.	RESISTOR	,FXD	,COMP				1		PADZZ
- 74	ERD50TJ102	54473	.	RESISTOR	,FXD	,COMP				1		PADZZ
- 75	RLR20C22R1FS	81349	.	RESISTOR	,FXD	,COMP				1		PADZZ
- 76	ERD50TJ271	54473	.	RESISTOR	,FXD	,COMP				1		PADZZ
- 77	RNC55K4640FS	81349	.	RESISTOR	,FXD	,FILM				1		PADZZ
- 78	RN55D8R25F	81349	.	RESISTOR	,FXD	,FILM				1		PADZZ
- 79	CF07-224J	78488	.	RESISTOR	,FXD	,COMP				1		PADZZ
- 80	RN55D4990F	81349	.	RESISTOR	,FXD	,FILM				1		PADZZ
- 81	CF07-222J	78488	.	RESISTOR	,FXD	,COMP				1		PADZZ
- 82	3386B-1-501	32997	.	RESISTOR	,VARIABLE					1		PADZZ
- 83	CF07-221J	78488	.	RESISTOR	,FXD	,COMP				1		PADZZ
- 84	CF07-682J	78488	.	RESISTOR	,FXD	,COMP				1		PADZZ
- 85	CF07-472J	78488	.	RESISTOR	,FXD	,COMP				2		PADZZ
- 86	CF07-332J	78488	.	RESISTOR	,FXD	,COMP				1		PADZZ
- 87	CF07-473J	78488	.	RESISTOR	,FXD	,COMP				1		PADZZ
- 88	10085-1224	14304	.	TRANSFORMER	,RF					1		PADZZ
- 89	51718	61735	.	TRANSFORMER	,RF					1		PADZZ
- 90	10085-1225	14304	.	TRANSFORMER	,RF					1		PADZZ
- 91	10085-1266	14304	.	TRANSFORMER	,RF					1		PADZZ
- 92	SG1524F	18324	.	MICROCIRCUIT						1		PADZZ
- 93	SE5561FE	18324	.	MICROCIRCUIT						1		PADZZ
- 94	1N4743A	81349	.	SEMICOND DEVICE	,DIO					1		PADZZ
- 95	JAN1N4463	81349	.	SEMICOND DEVICE	,DIO					2		PADZZ

Figure & Index Number	Part Number	FSCM	Description 1 2 3 4 5 6 7	Units	Usable	SMR
				Per Assy	On Code	
- 96	1N4738A	80131	. SEMICOND DEVICE,DIO	2		PADZZ
- 97	10085-1269	14304	. CIRCUIT CARD	1		XA
- 98	10085-1245	14304	. HEATSINK	1		XB
- 99	6611-0135	14304	. RETAINER,SCREW	4		PADZZ
-100	10085-5156	14304	. BUSHING	4		PADZZ
-101	MS51957-17	96906	. SCREW,MACHINE (AP)	4		PADZZ
-102	43-03-4	13103	. INSULATOR PLATE	2		PADZZ
-103	SM-66-52-14	08289	. INSULATOR PLATE	3		PADZZ
-104	61134-1	00779	. TERMINAL QUICK DISC	6		PADZZ
-105	KFH-440-8	99256	. STUD,CLINCH	6		XB
-106	7721-7PPS	13103	. INSULATOR BUSHING	3		PADZZ
-107	MS77068-1	96906	. TERMINAL,LUG	2		PADZZ
-108	2261-N116	06540	. WASHER,FLAT,NYLON	1		XB
-109	010440B112	73734	. SCREW,MACHINE,NYLON	3		XB
-110	103101	73734	. NUT NONMETALIC	3		PADZZ
-111	61060-1	00779	. TERMINAL	1		PADZZ
-112	MS24693-C5	96906	. SCREW,MACHINE (AP)	3		PAOZZ

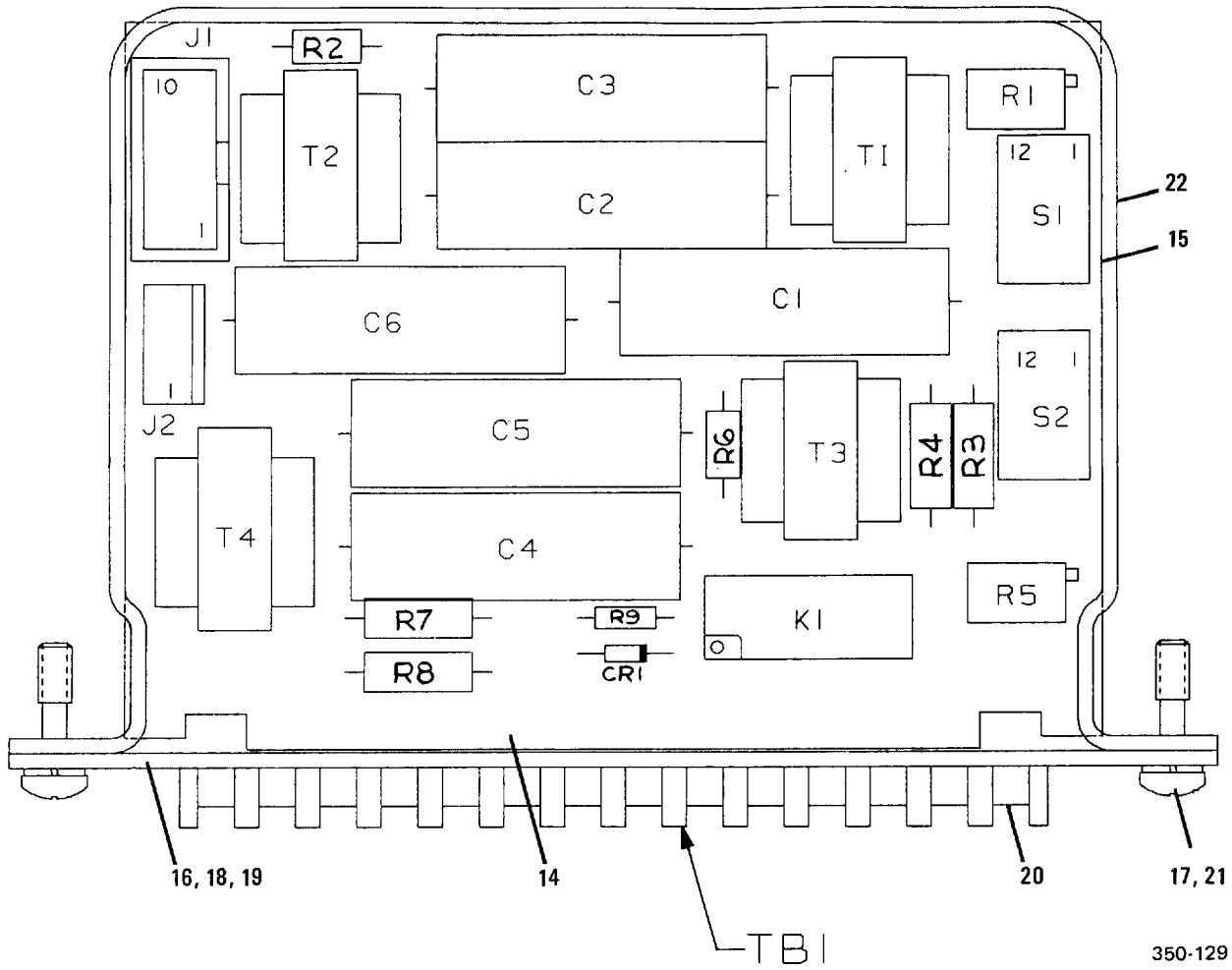

Figure 7-10. Audio Interface PWB Assy, A4

NOTE

To find index numbers for circuit board components, use the reference designator index at the end of this chapter. The complete reference designator for a circuit board component consists of "1," followed by the assembly designator (A1, A2, etc.), then the reference designator on the illustration. For example, the complete reference designator for R25 on the Front Panel PWB Assy is 1A1A1 R25.

Figure & Index Number	Part Number	FSCM	Description 1 2 3 4 5 6 7	Units	Usable	SMR Code
				Per Assy	On Code	
7-10-	10085-0570	14304	CIRCUIT CARD ASSY,A4	1		PAODD
- 1	JAN1N4454	81349	. SEMICOND DEVICE,DIO	1		PADZZ
- 2	7FR2052B	54904	. CAPACITOR,FXD,MYLAR	6		PADZZ
- 3	609-1027	15912	. CONNECTOR,RCPT,ELEC	1		PADZZ
- 4	22-11-2052	27264	. CONNECTOR,RCPT,ELEC	1		PADZZ
- 5	K-0118	14304	. RELAY	1		PADZZ
- 6	68XR2K	73138	. RESISTOR,VARIABLE	2		PADZZ
- 7	RN55D6040F	81349	. RESISTOR,FXD,FILM	2		PADZZ
- 8	RNC60K3010FS	81349	. RESISTOR,FXD,FILM	4		PADZZ
- 9	RN60D3010F	81349	. RESISTOR,FXD,FILM	4		PADZZ
- 10	CF07-680J	78488	. RESISTOR,FXD,COMP	1		PADZZ
- 11	MSS-4200	95146	. SWITCH	2		PADZZ
- 12	T-2220	26667	. TRANSFORMER,RF	4		PADZZ
- 13	SEPX-12	94464	. TERMINAL,STRIP	1		XB
- 14	10085-0579	14304	. CIRCUIT CARD	1		XA
- 15	10085-0576	14304	. RETAINER	1		XB
- 16	10085-0577	14304	. CIRCUIT CARD	1		XA
- 17	10085-5131	14304	. SCREW,MACHINE (AP)	2		PADZZ
- 18	MS35338-134	96906	. WASHER,SPLIT (AP)	4		PADZZ
- 19	MS51957-2	96906	. SCREW,MACHINE (AP)	4		PAOZZ
- 20	MS51957-3	96906	. SCREW,MACHINE (AP)	2		PAOZZ
- 21	MS35338-136	96906	. WASHER,SPLIT (AP)	2		PADZZ
- 22	10085-0578	14304	. LABEL	1		MDO



58,59,60,61

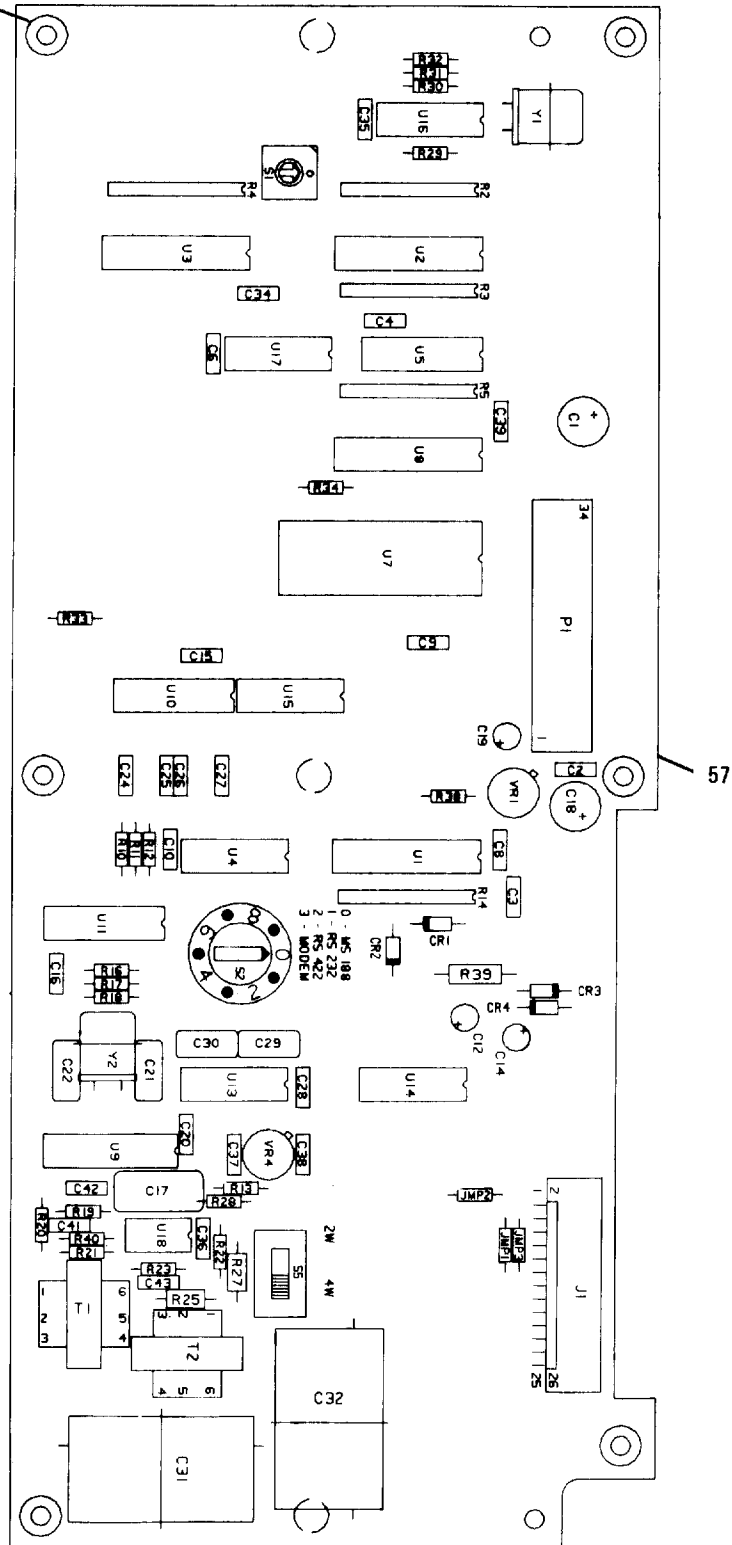

352-033

Figure 7-11. Remote Control Interface PWB Assy, A1A19

NOTE

To find index numbers for circuit board components, use the reference designator index at the end of this chapter. The complete reference designator for a circuit board component consists of "1," followed by the assembly designator (A1, A2, etc.), then the reference designator on the illustration. For example, the complete reference designator for R25 on the Front Panel PWB Assy is 1A1A1 R25.

Figure & Index Number	Part Number	FSCM	Description							Units Per Assy	Usable On Code	SMR Code
			1	2	3	4	5	6	7			
7-11-	10088-6000	14304	CIRCUIT CARD ASSY, 1A1A19 (in Transceiver)							1		PAODD
- 1	T392F157K010AS	31433	. CAP, FXD, ELCTLT							1		PADZZ
- 2	M39014/02-1350	81349	. CAPACITOR, FXD, CER							20		PADZZ
- 3	CK06BX104K	81349	. CAPACITOR, FXD, CER							18		PADZZ
- 4	T392B155M035AS	31433	. CAP, FXD, ELCTLT							3		PADZZ
- 5	CMR06F152G0DR	81349	. CAPACITOR, FXD, MICA							1		PADZZ
- 6	T392B335M025AS	31433	. CAP, FXD, ELCTLT							1		PADZZ
- 7	CMR05E220TODR	81349	. CAPACITOR, FXD, MICA							2		PADZZ
- 8	CM05ED220J03	81349	. CAPACITOR, FXD, MICA							2		PADZZ
- 9	M39014/01-1333	81349	. CAPACITOR, FXD, CER							4		PADZZ
- 10	CK05BX470K	81349	. CAPACITOR, FXD, CER							4		PADZZ
- 11	CMR05F201G0DR	81349	. CAPACITOR, FXD, MICA							2		PADZZ
- 12	CM05FD201G03	81349	. CAPACITOR, FXD, MICA							2		PADZZ
- 13	7FR2052B	54904	. CAPACITOR, FXD, MYLAR							2		PADZZ
- 14	M39014/02-1360	81349	. CAPACITOR, FXD, CER							1		PADZZ
- 15	CK06BX103K	81349	. CAPACITOR, FXD, CER							6		PADZZ
- 16	JAN1N3611	81349	. SEMICOND DEVICE, DIO							4		PADZZ
- 17	609-2607	59730	. CONNECTOR, RCPT, ELEC							1		PADZZ
- 18	MP-1142	14304	. CONTACT ELECTRICAL							3		XB
- 19	10088-6006	14304	. CABLE ASSY, RF							1		PADZZ
- 20	4310R-101-103	32997	. RESISTOR NETWORK							5		PADZZ
- 21	CF07-151J	78488	. RESISTOR, FXD, COMP							2		PADZZ
- 22	CF07-102J	78488	. RESISTOR, FXD, COMP							4		PADZZ
- 23	CF07-475J	78488	. RESISTOR, FXD, COMP							1		PADZZ
- 24	CF07-103J	78488	. RESISTOR, FXD, COMP							5		PADZZ
- 25	CF07-223J	78488	. RESISTOR, FXD, COMP							2		PADZZ
- 26	CF07-203J	78488	. RESISTOR, FXD, COMP							1		PADZZ
- 27	CF07-473J	78488	. RESISTOR, FXD, COMP							1		PADZZ
- 28	RNC55K6040FS	81349	. RESISTOR, FXD, FILM							2		PADZZ
- 29	RN55D6040F	81349	. RESISTOR, FXD, FILM							2		PADZZ
- 30	CF07-472J	78488	. RESISTOR, FXD, COMP							1		PADZZ
- 31	CF07-182J	78488	. RESISTOR, FXD, COMP							2		PADZZ
- 32	CF07-333J	78488	. RESISTOR, FXD, COMP							1		PADZZ
- 33	ERD50TJ101	54473	. RESISTOR, FXD, COMP							1		PADZZ
- 34	CFC ⁷ -393J	78488	. RESISTOR, FXD, COMP							1		PADZZ
- 35	DRD-10C	95146	. SWITCH, ROTARY							1		PADZZ
- 36	1-435097-1	00779	. SWITCH, ROTARY							1		PADZZ
- 37	MSS-4200	95146	. SWITCH, TOGGLE							1		PADZZ
- 38	T2106	04386	. TRANSFORMER, RF							2		PADZZ
- 39	M38510/32502BRB	81349	. MICROCIRCUIT							1		PADZZ
- 40	SN54LS245J	01295	. MICROCIRCUIT							3		PADZZ
- 41	M38510/30003BCB	81349	. MICROCIRCUIT							2		PADZZ
- 42	M38510/30701BEB	81349	. MICROCIRCUIT							1		PADZZ
- 43	SCN2661AA1I28	01295	. MICROCIRCUIT							1		PADZZ

Figure & Index Number	Part Number	FSCM	Description							Units Per Assy	Usable On Code	SMR Code
			1	2	3	4	5	6	7			
- 44	TMS99532NS	01295	.							1		PADZZ
- 45	AM26LS30DM	34335	.							1		PADZZ
- 46	7802002EB	14933	.							1		PADZZ
- 47	DS1489AJ	27014	.							1		PADZZ
- 48	MC1488LDS	04713	.							1		PADZZ
- 49	M38510/30301BCB	81349	.							1		PADZZ
- 50	SN54LS04J	01295	.							1		PADZZ
- 51	M38510/31004BCB	81349	.							1		PADZZ
- 52	MC1558U	04713	.							1		PADZZ
- 53	M38510/11501BXC	81349	.							1		PADZZ
- 54	M38510/10703BXC	81349	.							1		PADZZ
- 55	MP042	75378	.							1		PADZZ
- 56	FOX0432	61429	.							1		PADZZ
- 57	10088-6009	14304	.							1		XA
- 58	MS35338-135	96906	.							6		PAOZZ
- 59	MS51957-17	96906	.							6		PAOZZ
- 60	6611-0135	14304	.							6		XB
- 61	10085-5156	14304	.							6		XB

Section III. NUMERICAL INDEX

Part Number	Fig No.	Index No.	Qty per End Item	Part Number	Fig No.	Index No.	Qty per End Item
ADC0808CCJ	7-7	128	1	CF07-682J	7-9	84	3
AM26LS30DM	7-11	45	2	CF07-6R8J	7-9	52	2
AM26LS33DM	7-7	132	3	CF07-821J	7-7	93	1
CD4011BD/3	7-7	133	1	CF07-822J	7-7	90	1
CD4040BF	7-7	134	2	CF07-823J	7-7	78	5
CD4049BF	7-7	142	3	CK05BX102K	7-9	11	5
CD4051BD/3	7-7	135	1	CK05BX221K	7-7	18	2
CD4053BF	7-7	137	2	CK05BX470K	7-11	10	2
CD4094BF	7-5	41	3	CK06BX103K	7-11	15	10
CF07-100J	7-9	68	5	CK06BX104K	7-11	3	2
CF07-101J	7-5	28	3	CK06BX223K	7-9	21	3
CF07-102J	7-11	22	28	CK06BX224K	7-7	19	2
CF07-103J	7-11	24	65	CK06BX273K	7-9	24	3
CF07-104J	7-5	20	5	CK06BX332K	7-9	23	3
CF07-105J	7-7	94	3	CK06BX474K	7-7	20	11
CF07-122J	7-7	105	1	CM05ED220J03	7-11	8	2
CF07-123J	7-7	66	1	CM05FD201G03	7-11	12	2
CF07-124J	7-7	99	1	CM06FD152J03	7-7	8	3
CF07-151J	7-11	21	4	CMR05E220TODR	7-11	7	4
CF07-152J	7-7	103	1	CMR05F201GODR	7-11	11	4
CF07-153J	7-7	84	3	CMR06F152GODR	7-11	5	2
CF07-154J	7-5	22	3	CMR06F182GODR	7-7	23	1
CF07-182J	7-11	31	4	CMR06F362GODR	7-7	22	1
CF07-183J	7-7	88	1	CX02N156K	7-7	29	1
CF07-184J	7-7	97	2	DB24659-2	7-4	4	2
CF07-203J	7-11	26	2	DCM462T100EC2B	7-2	9	1
CF07-220J	7-9	51	6	DE24657	7-4	2	1
CF07-221J	7-9	83	3	DM53741-5059	7-2	2	5
CF07-222J	7-7	98	8	DM5416J	7-5	40	1
CF07-223J	7-11	25	6	DRD-10C	7-11	35	2
CF07-224J	7-7	71	3	DS1488J	7-7	123	3
CF07-244J	7-7	80	1	DS1489AJ	7-11	47	2
CF07-270J	7-7	102	1	E312-E0001	7-5	38	1
CF07-272J	7-7	91	3	ERD50TJ100	7-9	45	4
CF07-273J	7-7	77	6	ERD50TJ101	7-11	33	1
CF07-2R7J	7-7	92	5	ERD50TJ102	7-9	74	3
CF07-332J	7-9	86	3	ERD50TJ271	7-9	76	3
CF07-333J	7-11	32	12	FOX0432	7-11	56	2
CF07-334J	7-7	100	3	GC283	7-3	4	1
CF07-392J	7-7	89	1	H-0963	7-5	53	3
CF07-393J	7-11	34	10	H-6768	7-2	42	4
CF07-471J	7-7	73	6	H-6769	7-2	37	5
CF07-472J	7-11	30	9	H6767	7-2	30	5
CF07-473J	7-11	27	7	HLCDO438AY	7-6	6	5
CF07-475J	7-11	23	2	JAN1N3611	7-11	16	9
CF07-4R7J	7-7	83	1	JAN1N4454	7-10	1	3
CF07-561J	7-7	101	2	JAN1N4463	7-9	95	3
CF07-563J	7-7	74	2	JAN1N5417	7-9	28	16
CF07-623J	7-7	86	1	JAN1N750A	7-7	35	2
CF07-680J	7-10	10	3	JAN2N2219A	7-9	36	4
CF07-681J	7-7	56	4	JAN2N2222A	7-5	19	3

Part Number	Fig No.	Index No.	Qty per End Item	Part Number	Fig No.	Index No.	Qty per End Item
JAN2N2907A	7-7	52	3	MS14046-6	7-5	16	3
JAN2N3439	7-9	35	4	MS15795-803	7-1	6	15
JAN2N4091	7-7	53	2	MS15795-805	7-8	1	4
JAN2N6338	7-9	39	2	MS15795-806	7-7	161	1
JAN2N6341	7-9	38	2	MS15795-807	7-2	28	5
K-0118	7-10	5	1	MS15795-808	7-2	35	2
KFH-440-8	7-9	105	6	MS21266-1N	7-7	168	7
L13-0002-331	7-9	32	1	MS24693-C16	7-8	8	3
L13-0002-470	7-9	31	1	MS24693-C26	7-2	26	4
LM120H-5.0	7-7	146	3	MS24693-C272	7-1	12	4
M24243/1-B304	7-7	156	6	MS24693-C5	7-9	112	3
M24243/1-B402	7-7	157	16	MS3102R20-8P	7-2	14	1
M24243/5-B402	7-2	38	2	MS3106A20-8S	7-4	7	1
M24308/1-1	7-4	3	1	MS3367-4-9	7-7	170	23
M24308/1-3	7-4	5	2	MS35333-70	7-3	14	11
M38510/10703BXC	7-11	54	3	MS35333-76	7-5	54	3
M38510/11201BCB	7-7	138	1	MS35338-134	7-10	18	6
M38510/11501BXC	7-11	53	2	MS35338-135	7-11	58	28
M38510/17204BCB	7-7	143	1	MS35338-136	7-10	21	4
M38510/30003BCB	7-11	41	3	MS35338-138	7-2	34	1
M38510/30301BCB	7-11	49	3	MS35649-244	7-2	24	3
M38510/30501BCB	7-7	144	1	MS51957-14	7-3	15	9
M38510/30608BEB	7-5	35	3	MS51957-17	7-11	59	14
M38510/30701BEB	7-11	42	4	MS51957-18	7-1	4	2
M38510/31004BCB	7-11	51	3	MS51957-2	7-10	19	4
M38510/32502BRB	7-11	39	4	MS51957-28	7-7	163	7
M39014/01-1330	7-7	31	1	MS51957-3	7-10	20	2
M39014/01-1333	7-11	9	9	MS51958-63	7-2	33	1
M39014/01-1341	7-7	17	1	MS51959-4	7-2	25	4
M39014/01-1345	7-7	15	7	MS75085-7	7-7	48	4
M39014/02-1326	7-7	32	1	MS77068-1	7-9	107	4
M39014/02-1332	7-9	18	1	MS90538-20	7-5	17	3
M39014/02-1335	7-9	25	1	MSS-4200	7-10	11	2
M39014/02-1338	7-7	21	7	RCR32G102JS	7-9	43	2
M39014/02-1340	7-9	12	1	RCR32G271JS	7-7	87	1
M39014/02-1342	7-7	28	2	RCR42G122JS	7-2	18	1
M39014/02-1344	7-9	7	1	RCR42G221JS	7-9	44	1
M39014/02-1350	7-11	2	109	RE65GR562F	7-2	19	2
M39014/02-1354	7-7	26	1	RJR24FW104P	7-7	69	3
M39014/02-1356	7-7	14	10	RLR20C22R1FS	7-9	75	1
M39014/02-1360	7-11	14	14	RN55D1000F	7-9	69	3
M85049/41-12A	7-4	8	1	RN55D1003F	7-9	62	3
MC1488LDS	7-11	48	2	RN55D1151F	7-7	109	2
MC1558U	7-11	52	17	RN55D2211F	7-9	57	6
MD015E104MAA	7-5	1	17	RN55D3321F	7-9	65	3
MDA2501	7-2	13	1	RN55D4320F	7-7	108	2
MP-0745	7-5	52	2	RN55D4750F	7-9	73	3
MP-1142	7-11	18	8	RN55D4751F	7-3	10	3
MP042	7-11	55	1	RN55D4990F	7-9	80	3
MP150	7-7	152	1	RN55D4991F	7-9	53	4
MS-67-1-DC-WD	7-1	11	3	RN55D5112F	7-7	76	2

Part Number	Fig No.	Index No.	Qty per End Item	Part Number	Fig No.	Index No.	Qty per End Item
RN55D6040F	7-10	7	4	T392F157M016AS	7-7	25	1
RN55D6811F	7-9	61	5	T392F686M025AS	7-7	30	1
RN55D8R25F	7-9	78	1	TAPF10M25	7-5	4	4
RN55K2491FS	7-9	48	2	TC-105A	7-2	3	9
RN60D3010F	7-10	9	2	TD271-28-4	7-7	171	1
RNC55K1002FS	7-7	67	1	TD8031AH	7-7	115	1
RNC55K1102FS	7-9	59	1	TDA2002H	7-7	2	1
RNC55K1151FS	7-7	106	2	TLO71MJG	7-7	3	2
RNC55K1152FS	7-9	47	1	TMS99532NS	7-11	44	2
RNC55K1332FS	7-7	68	1	TY-23M	7-2	1	10
RNC55K2003FS	7-9	64	1	TY-304P	7-7	113	4
RNC55K2004FS	7-7	82	1	UA78M12HM	7-5	42	3
RNC55K2150FS	7-9	72	2	ULQ-2003R	7-7	140	1
RNC55K2432FS	7-7	95	1	V275LA40A	7-2	20	2
RNC55K3010FS	7-7	96	1	VA78M05HM	7-7	145	1
RNC55K4320FS	7-7	107	2	VHE1402	7-9	30	1
RNC55K4321FS	7-7	81	1	W58XB1A6A-1	7-2	10	2
RNC55K4640FS	7-9	77	4	W58XB1A6A-5	7-2	11	1
RNC55K5112FS	7-7	75	2	O10440B062	7-5	49	4
RNC55K6040FS	7-11	28	12	O10440B112	7-9	109	3
RNC55K8061FS	7-9	63	1	O180-2827	7-9	9	4
RNC60K23R7FS	7-9	71	1	0736-7232	7-6	1	2
RNC60K3010FS	7-10	8	4	08-56-0110	7-7	169	6
RUR-D820	7-9	29	1	1-435097-1	7-11	36	2
RW74U6R49F	7-5	29	1	10085-0008	7-1	1	1
SA571F	7-7	139	5	10085-0065	7-4	6	1
SA572F	7-7	141	1	10085-0337	7-7	49	1
SCN2661AA1I28	7-11	43	1	10085-0570	7-2	7	1
SE5561FE	7-9	93	1	10085-0576	7-10	15	1
SEPX-12	7-10	13	1	10085-0577	7-10	16	1
SG1524F	7-9	92	2	10085-0578	7-10	22	1
SM-66-52-14	7-9	103	3	10085-0579	7-10	14	1
SN54LS00J	7-5	34	3	10085-1209	7-8	3	1
SN54LS02J	7-7	126	4	10085-1224	7-9	88	1
SN54LS04J	7-11	50	2	10085-1225	7-9	90	1
SN54LS08J	7-7	121	4	10085-1228	7-9	33	1
SN54LS138J	7-5	32	3	10085-1230	7-8	6	1
SN54LS165J	7-7	116	3	10085-1240	7-2	6	1
SN54LS245J	7-11	40	4	10085-1245	7-9	98	1
SN54LS367AJ	7-5	37	4	10085-1247	7-8	5	1
SN54LS373J	7-7	120	5	10085-1260	7-8	4	1
SN54LS74AJ	7-5	39	3	10085-1266	7-9	91	1
T-2220	7-10	12	4	10085-1268	7-9	34	1
T2106	7-11	38	2	10085-1269	7-9	97	1
T392B106M010AS	7-5	2	3	10085-2000	7-2	4	1
T392B155M035AS	7-11	4	14	10085-2017	7-1	9	1
T392B335M025AS	7-11	6	32	10085-2019	7-3	11	1
T392C106M025AS	7-7	16	15	10085-2100	7-3	1	1
T392D226M025AS	7-9	14	3	10085-2105	7-5	44	1
T392F157K010AS	7-11	1	5	10085-2109	7-5	43	1
T392F157M010AS	7-7	6	6	10085-2110	7-3	2	1
				10085-2112	7-6	8	2

Part Number	Fig No.	Index No.	Qty per End Item	Part Number	Fig No.	Index No.	Qty per End Item
10085-2113	7-5	18	1	207377-1	7-2	15	3
10085-2120	7-6	3	1	207378-3	7-7	38	1
10085-2129	7-6	7	1	22-01-3037	7-3	9	3
10085-2141	7-5	23	1	22-01-3057	7-3	6	1
10085-2142	7-5	25	1	22-01-3087	7-3	7	6
10085-2143	7-5	24	1	22-11-2052	7-10	4	3
10085-2144	7-5	15	1	22-11-2082	7-7	39	1
10085-5131	7-10	17	4	22-12-2034	7-5	10	3
10085-5136	7-6	9	4	22-SLOTB-BRASS	7-1	8	1
10085-5156	7-11	61	10	2261-N116	7-5	51	2
10085-5159	7-2	23	2	22NTE-62	7-1	5	2
10085-5212	7-7	47	1	2813-03-16	7-5	50	7
10087-2011	7-3	12	4	2N4236	7-9	41	3
10087-2012	7-3	13	4	3299W-1-104	7-7	72	2
10087-5110	7-2	21	1	3299W-1-504	7-7	104	2
10088-0000	7-1		1	3386B-1-501	7-9	82	3
10088-0060	7-4		1	3386F-1-502	7-5	26	8
10088-0071	7-1	3	1	351-8434-010	7-7	136	3
10088-0072	7-2	39	1	429E3F99KGZ	7-6	2	1
10088-0100	7-1	2	1	43-03-4	7-9	102	5
10088-0105	7-2	40	3	4308R-101-102	7-5	30	1
10088-0304	7-7	148	1	4308R-101-472	7-5	27	1
10088-0305	7-7	149	1	4310R-101-103	7-11	20	15
10088-0500	7-2	8	1	4511-175-87-2N	7-2	31	1
10088-0504	7-2	32	2	5082-4655	7-5	8	3
10088-0505	7-2	22	1	51718	7-9	89	1
10088-5000	7-2	5	1	528-AG11D	7-7	151	1
10088-5009	7-7	154	1	53894-41	7-2	17	1
10088-5015	7-7	155	1	540-AG11D	7-7	150	1
10088-6000	7-4	1	1	54483-2	7-2	16	1
10088-6006	7-11	19	1	5710-8-20	7-7	160	6
10088-6009	7-11	57	1	588D205-12	7-4	9	6
10088-7021	7-7	41	1	609-1007	7-5	12	3
10088-9540	7-7	124	1	609-1027	7-10	3	3
101-BB-1029	7-2	36	4	609-1407	7-7	37	3
1010M	7-5	45	1	609-1607	7-7	43	1
103101	7-9	110	5	609-2027	7-7	44	2
10350-A-1032-2	7-1	10	2	609-2607	7-11	17	1
105-0858-001	7-7	114	1	61060-1	7-9	111	3
113	7-3	3	2	610PB	7-7	159	1
117-DBE-25PA	7-7	36	1	61134-1	7-9	104	6
1251-6823	7-7	42	2	6232-SS-0632	7-8	7	2
1251-8273	7-5	11	1	65474-001	7-7	164	2
1251-8274	7-5	13	1	65499-102	7-7	167	2
151-0625-00	7-9	40	1	65499-103	7-7	165	1
18097B-B0440-14	7-5	46	12	65516-110	7-6	5	2
199D225X9025BG2	7-5	3	1	6611-0135	7-11	60	10
1N4738A	7-9	96	2	672D108H015ET5C	7-9	17	1
1N4743A	7-9	94	2	672D128H025FV5J	7-7	24	1
205817-1	7-7	166	2	672D337H040ET5	7-9	5	7
207376-1	7-3	8	1	672D337H040ET50	7-9	16	2

Part Number	Fig No.	Index No.	Qty per End Item	Part Number	Fig No.	Index No.	Qty per End Item
672D476H040CD5C	7-9	22	2	7901401EB	7-5	36	1
672D477H025DS5J	7-5	6	3	7FR2052B	7-10	2	6
68XR2K	7-10	6	2	801591-31	7-9	6	2
70HFR20	7-2	12	1	804991-1	7-5	33	1
7101SDV70QE	7-5	31	1	8103908JB	7-7	131	1
72PM2K	7-9	46	1	82-32-101-20	7-2	41	4
7401T1ZGE	7-1	7	1	82-8666	7-3	5	1
7705801EB	7-7	119	2	87334-3	7-5	9	2
7721-7PPS	7-9	106	5	9725-SS-0440-7	7-3	19	9
7802002EB	7-11	46	2				

Section IV. REFERENCE DESIGNATOR INDEX

Reference Designation	Fig No.	Index No.	Reference Designation	Fig No.	Index No.	Reference Designation	Fig No.	Index No.
1A1	7-2	4	1A1A1R20	7-5	20	1A1R1	7-3	10
1A1A1	7-3	1	1A1A1R31	7-5	14			
1A1A1C1	7-5	1	1A1A1R34	7-5	14	1A2	7-2	5
1A1A1C2	7-5	2	1A1A1R36	7-5	14	1A2AR1	7-7	1
1A1A1C3	7-5	1	1A1A1R38	7-5	14	1A2AR2	7-7	1
1A1A1C4	7-5	1	1A1A1R40	7-5	14	1A2AR3	7-7	1
1A1A1C5	7-5	3	1A1A1R42	7-5	14	1A2AR4	7-7	2
1A1A1C6	7-5	1	1A1A1R44	7-5	14	1A2AR5	7-7	1
1A1A1C7	7-5	1	1A1A1R45	7-5	29	1A2AR6	7-7	1
1A1A1C8	7-5	1	1A1A1R46	7-5	30	1A2AR7	7-7	1
1A1A1C9	7-5	1	1A1A1R47	7-5	21	1A2AR8	7-7	1
1A1A1C10	7-5	1	1A1A1S1	7-5	31	1A2AR9	7-7	1
1A1A1C12	7-5	4	1A1A1U1	7-5	32	1A2AR10	7-7	1
1A1A1C13	7-5	4	1A1A1U2	7-5	33	1A2AR11	7-7	1
1A1A1C16	7-5	1	1A1A1U3	7-5	34	1A2AR12	7-7	1
1A1A1C17	7-5	5	1A1A1U4	7-5	35	1A2AR13	7-7	1
1A1A1C18	7-5	5	1A1A1U5	7-5	36	1A2AR14	7-7	1
1A1A1C19	7-5	1	1A1A1U7	7-5	37	1A2AR15	7-7	1
1A1A1C20	7-5	6	1A1A1U8	7-5	38	1A2AR16	7-7	1
1A1A1C21	7-5	1	1A1A1U9	7-5	39	1A2AR17	7-7	3
1A1A1C22	7-5	1	1A1A1U10	7-5	40	1A2AR18	7-7	3
1A1A1CR1	7-5	7	1A1A1U12	7-5	41	1A2C1	7-7	4
1A1A1CR2	7-5	7	1A1A1VR1	7-5	42	1A2C2	7-7	4
1A1A1DS1	7-5	8				1A2C3	7-7	4
1A1A1J1	7-5	9	1A1A2	7-3	2	1A2C5	7-7	4
1A1A1J2	7-5	9	1A1A2DS1	7-6	1	1A2C6	7-7	4
1A1A1J3	7-5	10	1A1A2DS2	7-6	1	1A2C7	7-7	4
1A1A1J4	7-5	11	1A1A2DS3	7-6	2	1A2C12	7-7	5
1A1A1J5	7-5	12	1A1A2DS4	7-6	2	1A2C13	7-7	4
1A1A1J6	7-5	13	1A1A2A1	7-6	3	1A2C14	7-7	4
1A1A1JMP1	7-5	14	1A1A2A1C1	7-6	4	1A2C17	7-7	4
1A1A1L1	7-5	15	1A1A2A1C2	7-6	4	1A2C18	7-7	6
1A1A1L2	7-5	16	1A1A2A1C3	7-6	4	1A2C19	7-7	4
1A1A1L3	7-5	17	1A1A2A1C4	7-6	4	1A2C20	7-7	4
1A1A1P1	7-5	18	1A1A2A1C5	7-6	4	1A2C21	7-7	4
1A1A1Q1	7-5	19	1A1A2A1P1	7-6	5	1A2C22	7-7	4
1A1A1R2	7-5	20	1A1A2A1P2	7-6	5	1A2C23	7-7	4
1A1A1R3	7-5	21	1A1A2A1U1	7-6	6	1A2C25	7-7	4
1A1A1R4	7-5	22	1A1A2A1U2	7-6	6	1A2C26	7-7	4
1A1A1R5	7-5	20	1A1A2A1U3	7-6	6	1A2C27	7-7	4
1A1A1R8	7-5	23	1A1A2A1U4	7-6	6	1A2C28	7-7	7
1A1A1R9	7-5	24	1A1A2A1U5	7-6	6	1A2C29	7-7	8
1A1A1R10	7-5	25	1A1A2A1	7-6	7	1A2C30	7-7	9
1A1A1R11	7-5	26	1A1J1	7-3	3	1A2C31	7-7	9
1A1A1R12	7-5	26	1A1J2	7-3	4	1A2C32	7-7	9
1A1A1R13	7-5	26	1A1J3	7-3	3	1A2C33	7-7	9
1A1A1R14	7-5	26	1A1LS1	7-3	5	1A2C34	7-7	4
1A1A1R15	7-5	26	1A1P1	7-3	6	1A2C35	7-7	10
1A1A1R16	7-5	26	1A1P2	7-3	7	1A2C36	7-7	10
1A1A1R18	7-5	27	1A1P3	7-3	8	1A2C37	7-7	4
1A1A1R19	7-5	28	1A1P4	7-3	9	1A2C38	7-7	11

Reference Designation	Fig No.	Index No.	Reference Designation	Fig No.	Index No.	Reference Designation	Fig No.	Index No.
1A2C39	7-7	11	1A2C103	7-7	18	1A2C155	7-7	4
1A2C40	7-7	6	1A2C104	7-7	12	1A2C156	7-7	4
1A2C41	7-7	4	1A2C105	7-7	16	1A2C157	7-7	4
1A2C42	7-7	6	1A2C106	7-7	19	1A2C158	7-7	4
1A2C43	7-7	12	1A2C107	7-7	20	1A2C159	7-7	4
1A2C44	7-7	4	1A2C108	7-7	16	1A2C160	7-7	4
1A2C45	7-7	4	1A2C109	7-7	4	1A2C161	7-7	4
1A2C46	7-7	4	1A2C110	7-7	5	1A2C162	7-7	4
1A2C47	7-7	13	1A2C111	7-7	16	1A2C163	7-7	4
1A2C48	7-7	13	1A2C112	7-7	4	1A2C164	7-7	4
1A2C49	7-7	4	1A2C113	7-7	24	1A2C165	7-7	4
1A2C50	7-7	4	1A2C114	7-7	20	1A2C166	7-7	4
1A2C52	7-7	4	1A2C115	7-7	16	1A2C167	7-7	20
1A2C53	7-7	4	1A2C116	7-7	25	1A2C168	7-7	5
1A2C54	7-7	12	1A2C117	7-7	4	1A2C169	7-7	16
1A2C55	7-7	12	1A2C118	7-7	26	1A2C170	7-7	4
1A2C56	7-7	4	1A2C119	7-7	27	1A2C171	7-7	4
1A2C57	7-7	6	1A2C120	7-7	5	1A2C172	7-7	4
1A2C58	7-7	4	1A2C121	7-7	16	1A2C173	7-7	4
1A2C68	7-7	5	1A2C122	7-7	5	1A2C174	7-7	4
1A2C69	7-7	5	1A2C123	7-7	4	1A2C175	7-7	4
1A2C70	7-7	5	1A2C124	7-7	20	1A2C176	7-7	19
1A2C71	7-7	14	1A2C125	7-7	28	1A2C177	7-7	18
1A2C72	7-7	15	1A2C126	7-7	5	1A2C178	7-7	12
1A2C73	7-7	16	1A2C127	7-7	16	1A2C179	7-7	12
1A2C74	7-7	4	1A2C128	7-7	4	1A2C180	7-7	5
1A2C75	7-7	9	1A2C129	7-7	19	1A2C182	7-7	20
1A2C76	7-7	17	1A2C130	7-7	19	1A2C183	7-7	4
1A2C79	7-7	16	1A2C131	7-7	5	1A2C184	7-7	4
1A2C80	7-7	18	1A2C132	7-7	12	1A2C185	7-7	4
1A2C81	7-7	19	1A2C133	7-7	29	1A2C186	7-7	4
1A2C82	7-7	4	1A2C134	7-7	20	1A2C189	7-7	4
1A2C83	7-7	16	1A2C135	7-7	19	1A2C190	7-7	4
1A2C84	7-7	5	1A2C136	7-7	5	1A2C191	7-7	4
1A2C85	7-7	20	1A2C137	7-7	5	1A2C192	7-7	4
1A2C86	7-7	5	1A2C138	7-7	18	1A2C193	7-7	4
1A2C87	7-7	18	1A2C139	7-7	4	1A2C194	7-7	4
1A2C88	7-7	19	1A2C140	7-7	19	1A2C195	7-7	4
1A2C89	7-7	20	1A2C141	7-7	18	1A2C196	7-7	4
1A2C90	7-7	5	1A2C142	7-7	5	1A2C197	7-7	4
1A2C91	7-7	21	1A2C143	7-7	4	1A2C198	7-7	12
1A2C92	7-7	16	1A2C145	7-7	4	1A2C199	7-7	16
1A2C94	7-7	4	1A2C146	7-7	5	1A2C200	7-7	5
1A2C95	7-7	22	1A2C147	7-7	4	1A2C201	7-7	5
1A2C96	7-7	23	1A2C148	7-7	30	1A2C202	7-7	5
1A2C97	7-7	4	1A2C149	7-7	4	1A2C203	7-7	4
1A2C98	7-7	5	1A2C150	7-7	31	1A2C204	7-7	4
1A2C99	7-7	20	1A2C151	7-7	16	1A2C205	7-7	4
1A2C100	7-7	16	1A2C152	7-7	5	1A2C207	7-7	5
1A2C101	7-7	5	1A2C153	7-7	5	1A2C208	7-7	4
1A2C102	7-7	19	1A2C154	7-7	4	1A2C209	7-7	4

Reference Designation	Fig No.	Index No.	Reference Designation	Fig No.	Index No.	Reference Designation	Fig No.	Index No.
1A2C210	7-7	5	1A2JMP2	7-7	45	1A2R51	7-7	69
1A2C211	7-7	4	1A2JMP3	7-7	45	1A2R52	7-7	70
1A2C212	7-7	4	1A2JMP5	7-7	45	1A2R53	7-7	70
1A2C213	7-7	12	1A2K1	7-7	46	1A2R54	7-7	58
1A2C214	7-7	32	1A2L1	7-7	47	1A2R55	7-7	64
1A2C215	7-7	7	1A2L2	7-7	48	1A2R56	7-7	64
1A2C216	7-7	7	1A2L3	7-7	48	1A2R57	7-7	71
1A2C217	7-7	7	1A2L4	7-7	48	1A2R58	7-7	54
1A2C218	7-7	7	1A2L5	7-7	48	1A2R59	7-7	72
1A2CR2	7-7	33	1A2P3	7-7	49	1A2R60	7-7	54
1A2CR3	7-7	33	1A2P5	7-7	50	1A2R61	7-7	70
1A2CR4	7-7	33	1A2Q1	7-7	51	1A2R62	7-7	64
1A2CR5	7-7	33	1A2Q2	7-7	52	1A2R63	7-7	54
1A2CR18	7-7	34	1A2Q3	7-7	53	1A2R64	7-7	58
1A2CR19	7-7	34	1A2Q4	7-7	53	1A2R65	7-7	63
1A2CR25	7-7	34	1A2R1	7-7	54	1A2R66	7-7	73
1A2CR26	7-7	35	1A2R2	7-7	55	1A2R69	7-7	60
1A2CR27	7-7	34	1A2R3	7-7	54	1A2R70	7-7	74
1A2CR29	7-7	34	1A2R5	7-7	56	1A2R71	7-7	54
1A2CR30	7-7	34	1A2R6	7-7	56	1A2R73	7-7	60
1A2CR31	7-7	34	1A2R7	7-7	54	1A2R74	7-7	64
1A2CR32	7-7	34	1A2R8	7-7	57	1A2R75	7-7	75
1A2CR33	7-7	34	1A2R9	7-7	57	1A2R76	7-7	76
1A2CR34	7-7	34	1A2R14	7-7	55	1A2R77	7-7	54
1A2CR35	7-7	34	1A2R16	7-7	58	1A2R78	7-7	77
1A2CR36	7-7	34	1A2R17	7-7	59	1A2R79	7-7	77
1A2CR37	7-7	34	1A2R18	7-7	58	1A2R80	7-7	77
1A2CR38	7-7	34	1A2R20	7-7	60	1A2R81	7-7	78
1A2CR39	7-7	35	1A2R21	7-7	60	1A2R82	7-7	78
1A2CR40	7-7	34	1A2R23	7-7	57	1A2R83	7-7	64
1A2CR41	7-7	34	1A2R24	7-7	61	1A2R84	7-7	79
1A2CR42	7-7	34	1A2R25	7-7	57	1A2R85	7-7	80
1A2CR43	7-7	34	1A2R26	7-7	57	1A2R86	7-7	74
1A2CR44	7-7	34	1A2R27	7-7	57	1A2R87	7-7	78
1A2CR45	7-7	34	1A2R29	7-7	62	1A2R88	7-7	78
1A2CR46	7-7	34	1A2R30	7-7	63	1A2R89	7-7	60
1A2CR47	7-7	34	1A2R34	7-7	57	1A2R90	7-7	70
1A2CR48	7-7	34	1A2R35	7-7	60	1A2R91	7-7	81
1A2CR49	7-7	34	1A2R36	7-7	64	1A2R92	7-7	82
1A2CR50	7-7	34	1A2R37	7-7	54	1A2R93	7-7	83
1A2CR51	7-7	34	1A2R38	7-7	64	1A2R94	7-7	70
1A2J1	7-7	36	1A2R39	7-7	65	1A2R95	7-7	70
1A2J2	7-7	37	1A2R40	7-7	57	1A2R96	7-7	54
1A2J3	7-7	38	1A2R41	7-7	57	1A2R97	7-7	84
1A2J4	7-7	39	1A2R44	7-7	54	1A2R98	7-7	85
1A2J5	7-7	40	1A2R45	7-7	66	1A2R99	7-7	60
1A2J6	7-7	41	1A2R46	7-7	64	1A2R100	7-7	54
1A2J7	7-7	42	1A2R47	7-7	54	1A2R101	7-7	54
1A2J8	7-7	43	1A2R48	7-7	54	1A2R102	7-7	64
1A2J9	7-7	44	1A2R49	7-7	67	1A2R103	7-7	70
1A2JMP1	7-7	45	1A2R50	7-7	68	1A2R104	7-7	85

Reference Designation	Fig No.	Index No.	Reference Designation	Fig No.	Index No.	Reference Designation	Fig No.	Index No.
1A2R105	7-7	54	1A2R159	7-7	92	1A2R210	7-7	60
1A2R106	7-7	54	1A2R160	7-7	60	1A2R211	7-7	54
1A2R107	7-7	54	1A2R161	7-7	100	1A2R212	7-7	54
1A2R108	7-7	79	1A2R162	7-7	98	1A2R213	7-7	54
1A2R109	7-7	86	1A2R163	7-7	54	1A2R214	7-7	54
1A2R110	7-7	65	1A2R164	7-7	98	1A2R215	7-7	54
1A2R111	7-7	64	1A2R165	7-7	94	1A2R216	7-7	54
1A2R112	7-7	70	1A2R166	7-7	101	1A2R220	7-7	54
1A2R113	7-7	58	1A2R167	7-7	77	1A2R221	7-7	54
1A2R114	7-7	64	1A2R168	7-7	54	1A2R222	7-7	98
1A2R115	7-7	87	1A2R169	7-7	54	1A2R223	7-7	55
1A2R116	7-7	64	1A2R170	7-7	61	1A2R224	7-7	100
1A2R117	7-7	54	1A2R171	7-7	73	1A2R225	7-7	54
1A2R118	7-7	64	1A2R172	7-7	79	1A2R226	7-7	54
1A2R119	7-7	58	1A2R173	7-7	101	1A2R227	7-7	100
1A2R120	7-7	64	1A2R174	7-7	79	1A2R228	7-7	54
1A2R121	7-7	70	1A2R175	7-7	79	1A2R229	7-7	54
1A2R122	7-7	59	1A2R176	7-7	79	1A2R230	7-7	60
1A2R123	7-7	88	1A2R177	7-7	54	1A2R231	7-7	60
1A2R124	7-7	89	1A2R178	7-7	54	1A2R232	7-7	64
1A2R125	7-7	54	1A2R179	7-7	54	1A2R233	7-7	106
1A2R126	7-7	79	1A2R180	7-7	54	1A2R234	7-7	107
1A2R127	7-7	90	1A2R181	7-7	54	1A2R235	7-7	108
1A2R128	7-7	57	1A2R182	7-7	65	1A2R236	7-7	109
1A2R129	7-7	85	1A2R183	7-7	84	1A2R237	7-7	54
1A2R130	7-7	91	1A2R184	7-7	102	1A2R238	7-7	54
1A2R131	7-7	92	1A2R185	7-7	61	1A2R239	7-7	54
1A2R132	7-7	93	1A2R186	7-7	64	1A2R240	7-7	72
1A2R133	7-7	55	1A2R187	7-7	54	1A2R241	7-7	54
1A2R134	7-7	54	1A2R188	7-7	61	1A2R242	7-7	60
1A2R135	7-7	64	1A2R189	7-7	103	1A2R243	7-7	54
1A2R136	7-7	64	1A2R190	7-7	71	1A2R244	7-7	104
1A2R138	7-7	54	1A2R191	7-7	64	1A2R245	7-7	54
1A2R139	7-7	94	1A2R192	7-7	54	1A2R246	7-7	58
1A2R140	7-7	95	1A2R193	7-7	64	1A2R247	7-7	56
1A2R141	7-7	96	1A2R194	7-7	98	1A2R248	7-7	84
1A2R142	7-7	64	1A2R195	7-7	104	1A2R249	7-7	70
1A2R143	7-7	97	1A2R196	7-7	65	1A2R250	7-7	98
1A2R146	7-7	78	1A2R197	7-7	105	1A2R251	7-7	98
1A2R147	7-7	98	1A2R198	7-7	94	1A2R252	7-7	79
1A2R148	7-7	97	1A2R199	7-7	65	1A2S3	7-7	110
1A2R149	7-7	58	1A2R200	7-7	60	1A2S4	7-7	111
1A2R150	7-7	64	1A2R201	7-7	60	1A2S5	7-7	112
1A2R151	7-7	64	1A2R202	7-7	60	1A2T1	7-7	113
1A2R152	7-7	54	1A2R203	7-7	60	1A2T2	7-7	113
1A2R153	7-7	64	1A2R204	7-7	60	1A2T3	7-7	113
1A2R154	7-7	61	1A2R205	7-7	60	1A2T4	7-7	113
1A2R155	7-7	99	1A2R206	7-7	54	1A2TP1	7-7	114
1A2R156	7-7	60	1A2R207	7-7	60	1A2U1	7-7	115
1A2R157	7-7	54	1A2R208	7-7	60	1A2U3	7-7	116
1A2R158	7-7	92	1A2R209	7-7	60	1A2U4	7-7	117

Reference Designation	Fig No.	Index No.	Reference Designation	Fig No.	Index No.	Reference Designation	Fig No.	Index No.
1A2U5	7-7	118	1A3A1C3	7-9	7	1A3A1CR22	7-9	27
1A2U6	7-7	119	1A3A1C4	7-9	8	1A3A1CR23	7-9	28
1A2U7	7-7	120	1A3A1C5	7-9	8	1A3A1CR24	7-9	27
1A2U8	7-7	121	1A3A1C6	7-9	8	1A3A1L1	7-9	31
1A2U9	7-7	122	1A3A1C7	7-9	9	1A3A1L2	7-9	32
1A2U10	7-7	123	1A3A1C8	7-9	8	1A3A1L3	7-9	33
1A2U12	7-7	124	1A3A1C9	7-9	10	1A3A1L4	7-9	34
1A2U13	7-7	125	1A3A1C10	7-9	11	1A3A1Q1	7-9	35
1A2U14	7-7	120	1A3A1C11	7-9	12	1A3A1Q3	7-9	36
1A2U15	7-7	126	1A3A1C12	7-9	10	1A3A1Q4	7-9	36
1A2U16	7-7	127	1A3A1C13	7-9	13	1A3A1Q6	7-9	37
1A2U17	7-7	120	1A3A1C14	7-9	14	1A3A1Q7	7-9	37
1A2U18	7-7	128	1A3A1C15	7-9	15	1A3A1Q8	7-9	38
1A2U19	7-7	129	1A3A1C16	7-9	16	1A3A1Q9	7-9	39
1A2U22	7-7	130	1A3A1C17	7-9	10	1A3A1Q10	7-9	40
1A2U25	7-7	131	1A3A1C18	7-9	10	1A3A1Q11	7-9	41
1A2U26	7-7	132	1A3A1C19	7-9	16	1A3A1Q12	7-9	42
1A2U27	7-7	133	1A3A1C20	7-9	16	1A3A1Q13	7-9	35
1A2U29	7-7	134	1A3A1C21	7-9	17	1A3A1Q14	7-9	42
1A2U30	7-7	125	1A3A1C22	7-9	13	1A3A1R1	7-9	43
1A2U32	7-7	126	1A3A1C23	7-9	15	1A3A1R2	7-9	44
1A2U33	7-7	135	1A3A1C24	7-9	11	1A3A1R3	7-9	45
1A2U34	7-7	136	1A3A1C25	7-9	18	1A3A1R4	7-9	46
1A2U35	7-7	137	1A3A1C26	7-9	19	1A3A1R5	7-9	47
1A2U36	7-7	138	1A3A1C27	7-9	20	1A3A1R6	7-9	48
1A2U37	7-7	137	1A3A1C28	7-9	20	1A3A1R7	7-9	49
1A2U40	7-7	139	1A3A1C29	7-9	16	1A3A1R8	7-9	49
1A2U41	7-7	139	1A3A1C30	7-9	16	1A3A1R9	7-9	50
1A2U42	7-7	139	1A3A1C31	7-9	11	1A3A1R10	7-9	50
1A2U43	7-7	139	1A3A1C32	7-9	13	1A3A1R11	7-9	51
1A2U44	7-7	139	1A3A1C33	7-9	13	1A3A1R12	7-9	51
1A2U45	7-7	140	1A3A1C34	7-9	8	1A3A1R13	7-9	52
1A2U46	7-7	141	1A3A1C35	7-9	21	1A3A1R14	7-9	52
1A2U48	7-7	142	1A3A1C36	7-9	8	1A3A1R15	7-9	53
1A2U49	7-7	143	1A3A1C37	7-9	22	1A3A1R16	7-9	53
1A2U50	7-7	144	1A3A1C38	7-9	23	1A3A1R17	7-9	54
1A2VR1	7-7	145	1A3A1C39	7-9	24	1A3A1R18	7-9	54
1A2VR2	7-7	146	1A3A1C40	7-9	25	1A3A1R19	7-9	55
1A2VR5	7-7	147	1A3A1CR1	7-9	26	1A3A1R20	7-9	45
1A2W1	7-7	148	1A3A1CR2	7-9	27	1A3A1R21	7-9	56
1A2W2	7-7	149	1A3A1CR3	7-9	27	1A3A1R22	7-9	57
1A2XU1	7-7	150	1A3A1CR4	7-9	27	1A3A1R23	7-9	58
1A2XU12	7-7	151	1A3A1CR5	7-9	27	1A3A1R24	7-9	59
1A2Y1	7-7	152	1A3A1CR8	7-9	28	1A3A1R25	7-9	60
1A2Y2	7-7	153	1A3A1CR9	7-9	28	1A3A1R26	7-9	61
			1A3A1CR10	7-9	28	1A3A1R27	7-9	62
1A3	7-2	6	1A3A1CR11	7-9	28	1A3A1R28	7-9	63
1A3A1	7-8	4	1A3A1CR12	7-9	29	1A3A1R29	7-9	64
1A3A1AR1	7-9	4	1A3A1CR13	7-9	30	1A3A1R30	7-9	55
1A3A1C1	7-9	5	1A3A1CR16	7-9	28	1A3A1R31	7-9	58
1A3A1C2	7-9	6	1A3A1CR17	7-9	28	1A3A1R32	7-9	65

Reference Designation	Fig No.	Index No.	Reference Designation	Fig No.	Index No.	Reference Designation	Fig No.	Index No.
1A3A1R33	7-9	60	1A4	7-2	7	1A1A19C4	7-11	3
1A3A1R34	7-9	66	1A4CR1	7-10	1	1A1A19C6	7-11	3
1A3A1R35	7-9	67	1A4C1	7-10	2	1A1A19C8	7-11	3
1A3A1R36	7-9	50	1A4C2	7-10	2	1A1A19C9	7-11	3
1A3A1R37	7-9	68	1A4C3	7-10	2	1A1A19C10	7-11	3
1A3A1R38	7-9	69	1A4C4	7-10	2	1A1A19C12	7-11	4
1A3A1R39	7-9	51	1A4C5	7-10	2	1A1A19C14	7-11	4
1A3A1R40	7-9	68	1A4C6	7-10	2	1A1A19C15	7-11	3
1A3A1R41	7-9	70	1A4J1	7-10	3	1A1A19C16	7-11	3
1A3A1R42	7-9	71	1A4J2	7-10	4	1A1A19C17	7-11	5
1A3A1R43	7-9	72	1A4K1	7-10	5	1A1A19C18	7-11	6
1A3A1R44	7-9	73	1A4R1	7-10	6	1A1A19C19	7-11	4
1A3A1R45	7-9	74	1A4R2	7-10	7	1A1A19C20	7-11	3
1A3A1R46	7-9	75	1A4R3	7-10	8	1A1A19C21	7-11	7
1A3A1R47	7-9	76	1A4R4	7-10	9	1A1A19C22	7-11	8
1A3A1R48	7-9	77	1A4R5	7-10	6	1A1A19C24	7-11	9
1A3A1R49	7-9	78	1A4R6	7-10	7	1A1A19C25	7-11	10
1A3A1R50	7-9	67	1A4R7	7-10	9	1A1A19C26	7-11	10
1A3A1R51	7-9	60	1A4R8	7-10	9	1A1A19C27	7-11	10
1A3A1R52	7-9	61	1A4R9	7-10	10	1A1A19C28	7-11	3
1A3A1R53	7-9	61	1A4S1	7-10	11	1A1A19C29	7-11	11
1A3A1R54	7-9	79	1A4S2	7-10	11	1A1A19C30	7-11	12
1A3A1R55	7-9	57	1A4T1	7-10	12	1A1A19C31	7-11	13
1A3A1R56	7-9	80	1A4T2	7-10	12	1A1A19C32	7-11	13
1A3A1R57	7-9	81	1A4T3	7-10	12	1A1A19C34	7-11	3
1A3A1R58	7-9	57	1A4T4	7-10	12	1A1A19C35	7-11	3
1A3A1R59	7-9	57	1A4TB1	7-10	13	1A1A19C36	7-11	3
1A3A1R60	7-9	70				1A1A19C37	7-11	3
1A3A1R61	7-9	82	1C1	7-2	9	1A1A19C38	7-11	14
1A3A1R62	7-9	51	1CB1	7-2	10	1A1A19C39	7-11	3
1A3A1R63	7-9	83	1CB2	7-2	10	1A1A19C41	7-11	3
1A3A1R64	7-9	70	1CB3	7-2	11	1A1A19C42	7-11	3
1A3A1R65	7-9	60	1CR1	7-2	12	1A1A19C43	7-11	15
1A3A1R66	7-9	84	1CR2	7-2	13	1A1A19CR1	7-11	16
1A3A1R67	7-9	85	1J1	7-2	14	1A1A19CR2	7-11	16
1A3A1R68	7-9	70	1J2	7-2	15	1A1A19CR3	7-11	16
1A3A1R69	7-9	86	1J3	7-2	15	1A1A19CR4	7-11	16
1A3A1R70	7-9	68	1J4	7-2	16	1A1A19J1	7-11	17
1A3A1R71	7-9	50	1P1	7-2	15	1A1A19JMP1	7-11	18
1A3A1R72	7-9	87	1P2	7-2	17	1A1A19JMP2	7-11	18
1A3A1R73	7-9	85	1R1	7-2	18	1A1A19JMP3	7-11	18
1A3A1T1	7-9	88	1R2	7-2	19	1A1A19P1	7-11	19
1A3A1T2	7-9	89	1R3	7-2	19	1A1A19R2	7-11	20
1A3A1T3	7-9	90	1RV1	7-2	20	1A1A19R3	7-11	20
1A3A1T4	7-9	91	1RV2	7-2	20	1A1A19R4	7-11	20
1A3A1U1	7-9	92	1S1	7-1	7	1A1A19R5	7-11	20
1A3A1U2	7-9	93	1T1	7-2	21	1A1A19R10	7-11	21
1A3A1VR1	7-9	94				1A1A19R11	7-11	22
1A3A1VR2	7-9	95	1A1A19C1	7-11	1	1A1A19R12	7-11	22
1A3A1VR3	7-9	96	1A1A19C2	7-11	2	1A1A19R13	7-11	23
1A3A2	7-8	6	1A1A19C3	7-11	3	1A1A19R14	7-11	20

Reference Designation	Fig No.	Index No.	Reference Designation	Fig No.	Index No.	Reference Designation	Fig No.	Index No.
1A1A19R16	7-11	22	1A1A19R33	7-11	24	1A1A19U7	7-11	43
1A1A19R17	7-11	22	1A1A19R34	7-11	24	1A1A19U8	7-11	40
1A1A19R18	7-11	21	1A1A19R38	7-11	24	1A1A19U9	7-11	44
1A1A19R19	7-11	24	1A1A19R39	7-11	33	1A1A19U10	7-11	45
1A1A19R20	7-11	24	1A1A19R40	7-11	34	1A1A19U11	7-11	46
1A1A19R21	7-11	25	1A1A19S1	7-11	35	1A1A19U13	7-11	47
1A1A19R22	7-11	26	1A1A19S2	7-11	36	1A1A19U14	7-11	48
1A1A19R23	7-11	27	1A1A19S5	7-11	37	1A1A19U15	7-11	49
1A1A19R25	7-11	28	1A1A19T1	7-11	38	1A1A19U16	7-11	50
1A1A19R27	7-11	29	1A1A19T2	7-11	38	1A1A19U17	7-11	51
1A1A19R28	7-11	25	1A1A19U1	7-11	39	1A1A19U18	7-11	52
1A1A19R29	7-11	30	1A1A19U2	7-11	40	1A1A19VR1	7-11	53
1A1A19R30	7-11	31	1A1A19U3	7-11	40	1A1A19VR4	7-11	54
1A1A19R31	7-11	31	1A1A19U4	7-11	41	1A1A19Y1	7-11	55
1A1A19R32	7-11	32	1A1A19U5	7-11	42	1A1A19Y2	7-11	56

CHAPTER 8
FOLDOUT DRAWINGS

LIST OF REMOTE CONTROL FOLDOUT DRAWINGS

- FO-1 Family Tree Remote Control
- FO-2 Interconnection Diagram
- FO-3 Front Panel Assy, A1
- FO-4 Front Panel PWB Assy, A1A1
- FO-5 Display Assy, A1A2
- FO-6 Audio/Microprocessor PWB Assy, A2
- FO-7 Multivoltage Supply PWB Assy, A3
- FO-8 Audio Interface PWB Assy, A4
- FO-9 Remote Control Interface PWB Assy, A1A19 (in Transceiver)

NOTES:
 1. THE 10088-6000 ASSEMBLY IS INSTALLED
 IN THE TRANSCEIVER WHEN THE REMOTE
 CONTROL OPTION IS USED.

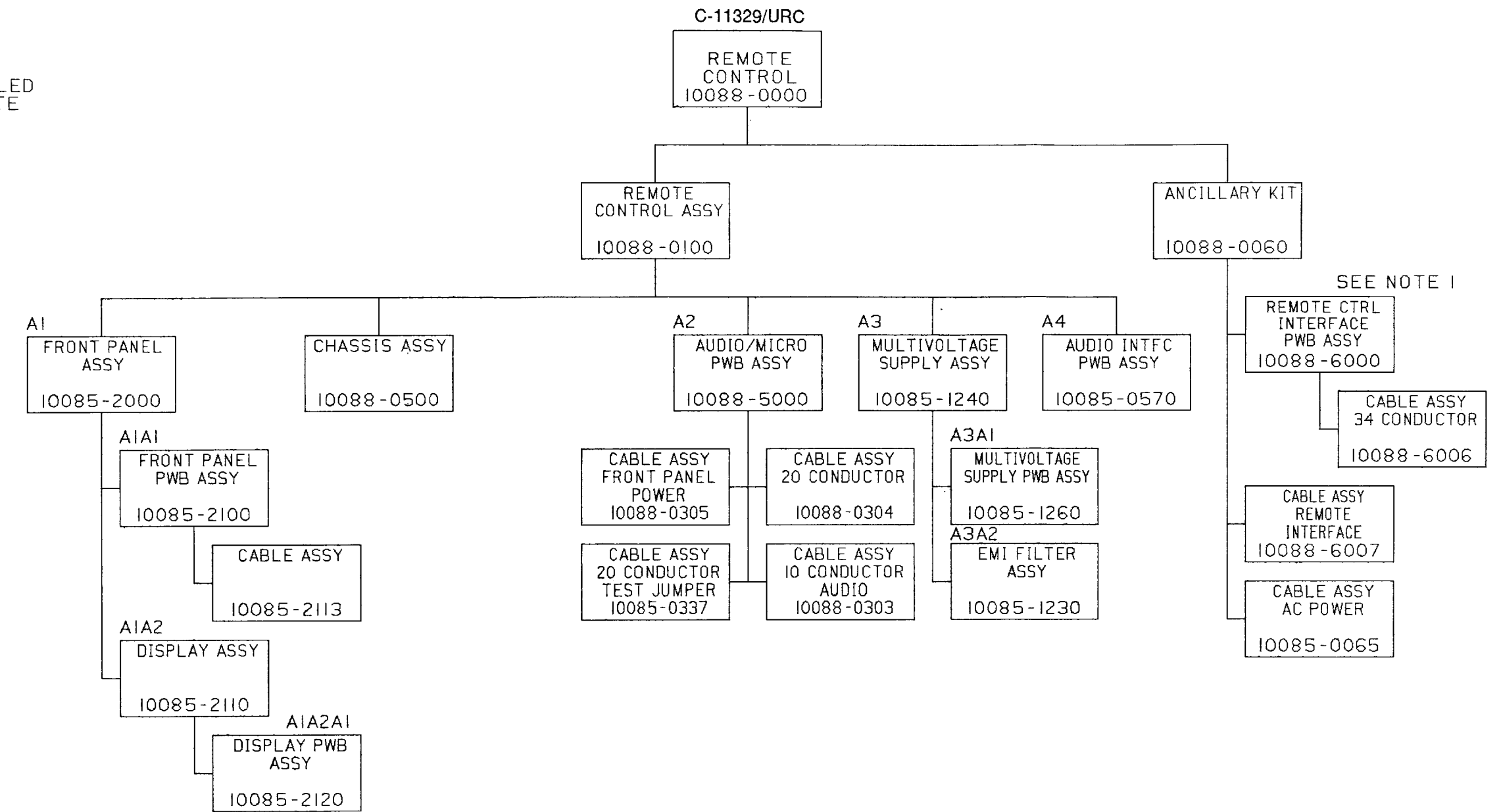

NOTE: UNLESS OTHERWISE SPECIFIED:

1. PARTIAL REFERENCE DESIGNATIONS ARE SHOWN FOR DETAIL PARTS. PREFIX THESE WITH UNIT NO. AND/OR ASSEMBLY DESIGNATIONS SHOWN ON DRAWING TO OBTAIN COMPLETE DESIGNATIONS.
2. ALL RESISTOR VALUES ARE IN OHMS, 1/4W, ±5%.
3. ALL CAPACITOR VALUES ARE IN MICROFARADS (UF).
4. ALL INDUCTANCE VALUES ARE IN MILLIHENRIES (MH).
5. VENDOR PART NO. CALLOUTS ARE FOR REFERENCE ONLY. COMPONENTS ARE SUPPLIED PER PART NO. IN PARTS LIST.
6. DC RESISTANCES OF INDUCTIVE ELEMENTS (CHOKES, COILS, MOTOR WINDINGS, ETC.) ARE LESS THAN 1 OHM.
7. PANEL DECALS ARE INDICATED BY BOLD TYPE IN A BOLD BOX, E.G., **ON/OFF**
8. ALL RELAYS ARE SHOWN IN THE DE-ENERGIZED STATE.

HIGHEST REFERENCE DESIGNATION	
REFERENCE DESIGNATIONS NOT USED	

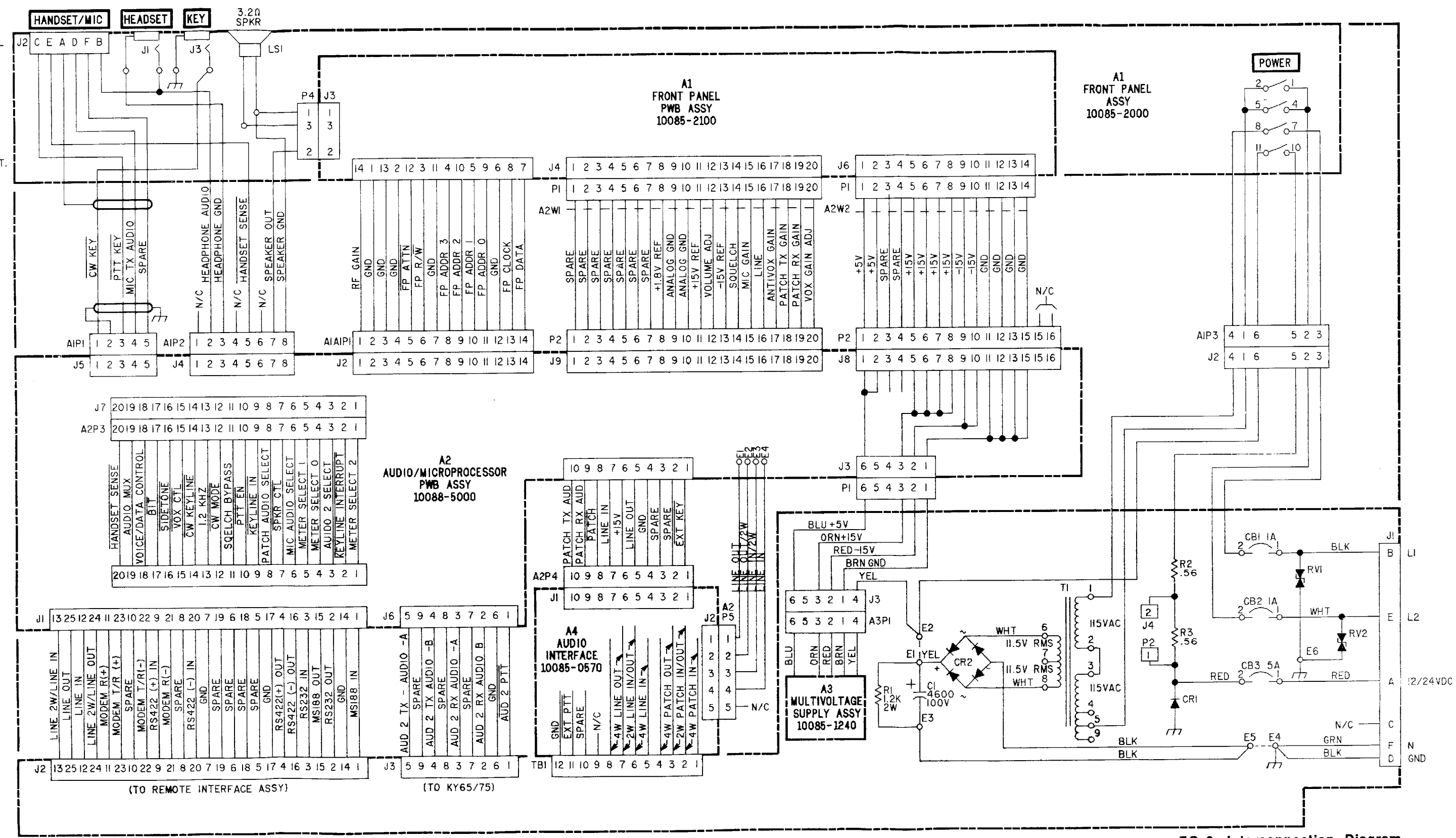

FO-2. Interconnection Diagram

NOTE: UNLESS OTHERWISE SPECIFIED:

1. PARTIAL REFERENCE DESIGNATIONS ARE SHOWN FOR DETAIL PARTS. PREFIX THESE WITH UNIT NO. AND/OR ASSEMBLY DESIGNATIONS SHOWN ON DRAWING TO OBTAIN COMPLETE DESIGNATIONS.
2. ALL RESISTOR VALUES ARE IN OHMS, 1/4W, ±5%.
3. ALL CAPACITOR VALUES ARE IN MICROFARADS (UF).
4. ALL INDUCTANCE VALUES ARE IN MILLIHENRIES (MH).
5. VENDOR PART NO. CALLOUTS ARE FOR REFERENCE ONLY. COMPONENTS ARE SUPPLIED PER PART NO. IN PARTS LIST.
6. DC RESISTANCES OF INDUCTIVE ELEMENTS (CHOKES, COILS, MOTOR WINDINGS, ETC.) ARE LESS THAN 1 OHM.
7. PANEL DECALS ARE INDICATED BY BOLD TYPE IN A BOLD BOX, E.G., **ON/OFF**
8. ALL RELAYS ARE SHOWN IN THE DE-ENERGIZED STATE.

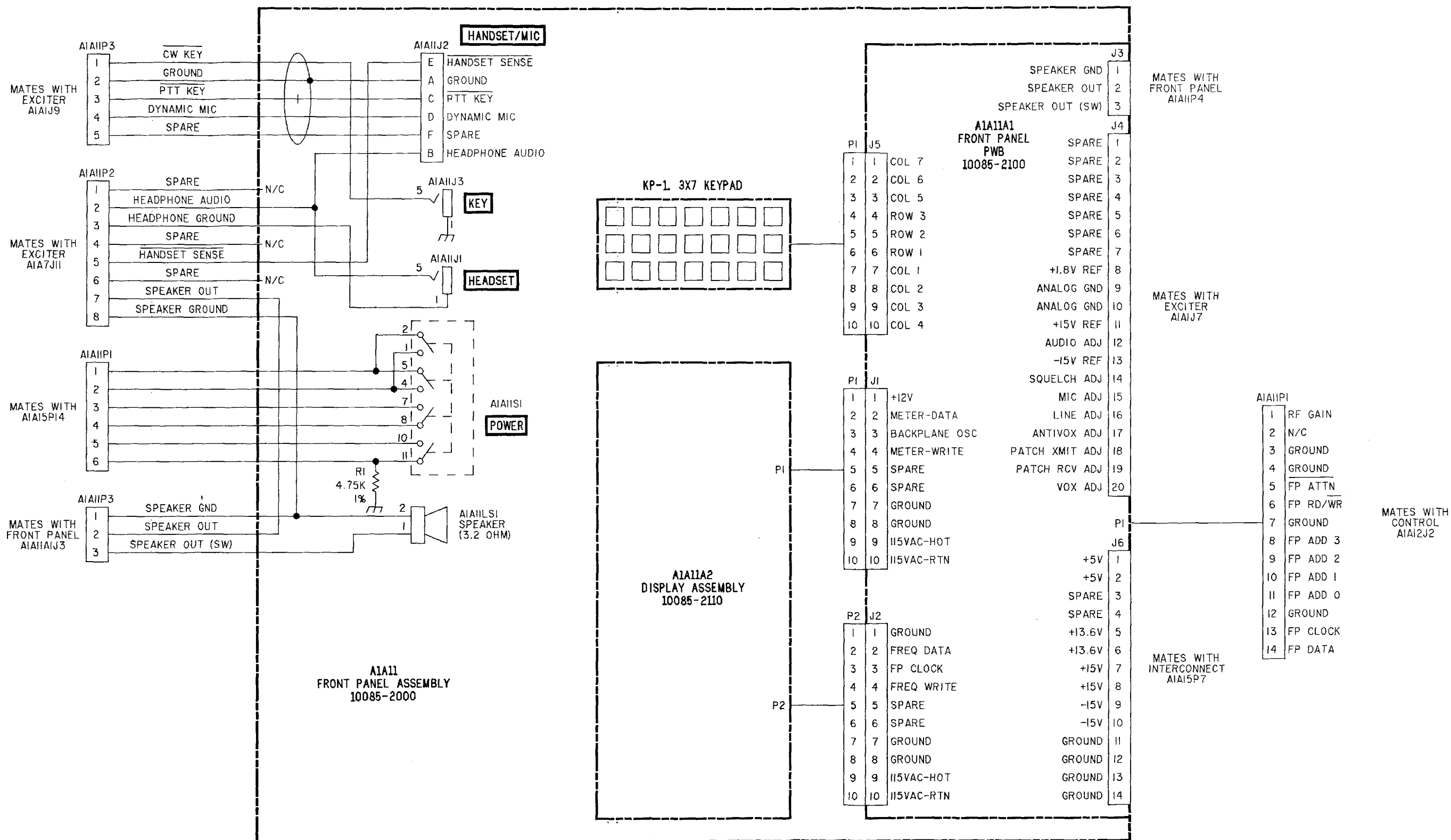

FO-3. Front Panel Assy, A1

NOTE: UNLESS OTHERWISE SPECIFIED:

1. PARTIAL REFERENCE DESIGNATIONS ARE SHOWN FOR DETAIL PARTS. PREFIX THESE WITH UNIT NO. AND/OR ASSEMBLY DESIGNATIONS SHOWN ON DRAWING TO OBTAIN COMPLETE DESIGNATIONS.
2. ALL RESISTOR VALUES ARE IN OHMS, 1/4W, ±5%.
3. ALL CAPACITOR VALUES ARE IN MICROFARADS (µF).
4. ALL INDUCTANCE VALUES ARE IN MICROHENRIES (µH).
5. VENDOR PART NO. CALLOUTS ARE FOR REFERENCE ONLY. COMPONENTS ARE SUPPLIED PER PART NO. IN PARTS LIST.
6. DC RESISTANCES OF INDUCTIVE ELEMENTS (CHOKES, COILS, MOTOR WINDINGS, ETC.,) ARE LESS THAN 1 OHM.
7. PANEL DECALS ARE INDICATED BY BOLD TYPE IN A BOLD BOX, E.G., **ON/OFF**.
8. ALL RELAYS ARE SHOWN IN THE DE-ENERGIZED STATE.
9. ●-4 SHOWS W1 CONNECTION AT PWB FOR P1.

HIGHEST REFERENCE DESIGNATION

REFERENCE DESIGNATIONS NOT USED

UNUSED GATES

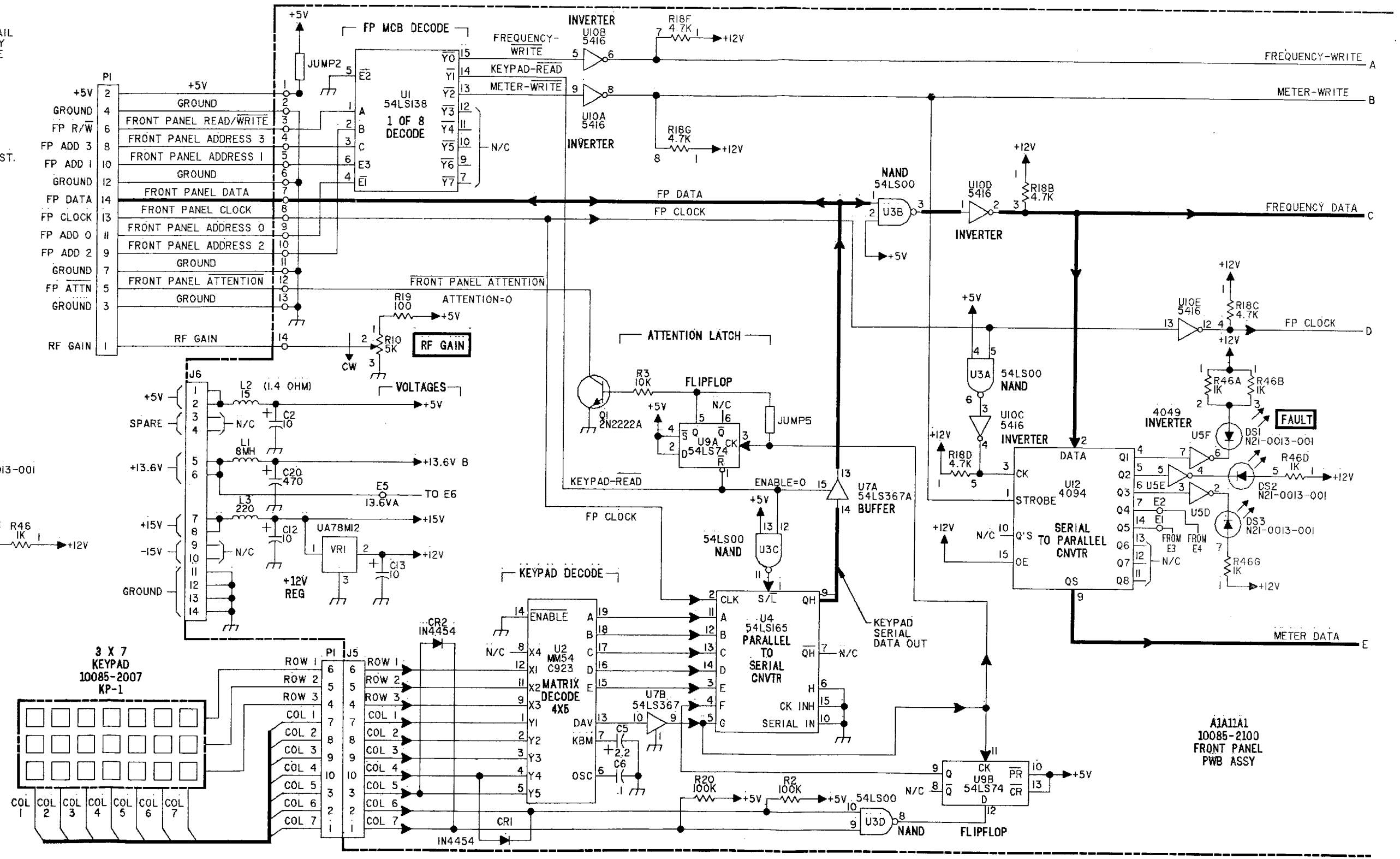
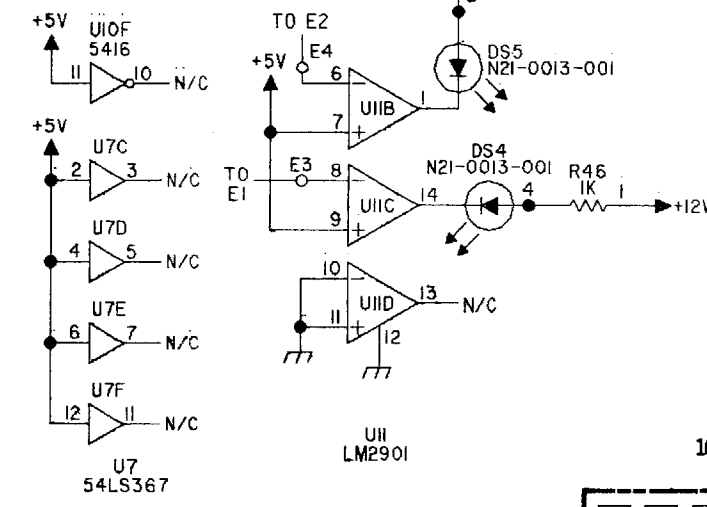

FO-4. Front Panel PWB Assy, A1A1 (Sheet 1 of 2)

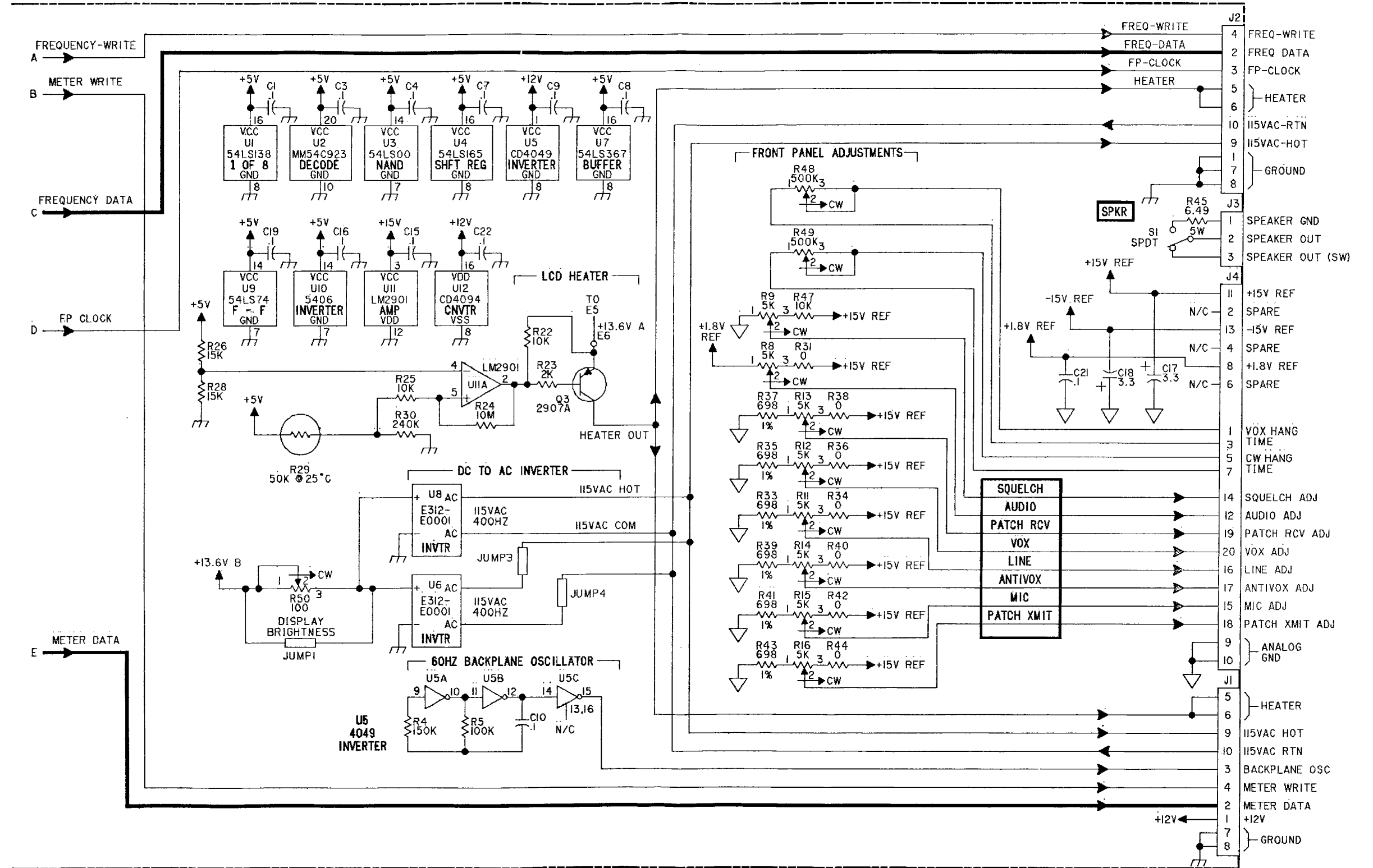

FO-4. Front Panel PWB Assy, A1A1
(Sheet 2 of 2)

NOTE: UNLESS OTHERWISE SPECIFIED:

1. PARTIAL REFERENCE DESIGNATIONS ARE SHOWN FOR DETAIL PARTS. PREFIX THESE WITH UNIT NO. AND/OR ASSEMBLY DESIGNATIONS SHOWN ON DRAWING TO OBTAIN COMPLETE DESIGNATIONS.
2. ALL RESISTOR VALUES ARE IN OHMS, 1/4W, ±5%.
3. ALL CAPACITOR VALUES ARE IN MICROFARADS (UF).
4. ALL INDUCTANCE VALUES ARE IN MILLIHENRIES (MH).
5. VENDOR PART NO. CALLOUTS ARE FOR REFERENCE ONLY. COMPONENTS ARE SUPPLIED PER PART NO. IN PARTS LIST.
6. DC RESISTANCES OF INDUCTIVE ELEMENTS (CHOKES, COILS, MOTOR WINDINGS, ETC.) ARE LESS THAN 1 OHM.
7. PANEL DECALS ARE INDICATED BY BOLD TYPE IN A BOLD BOX, E.G., **ON/OFF**.
8. ALL RELAYS ARE SHOWN IN THE DE-ENERGIZED STATE.

HIGHEST REFERENCE DESIGNATION			
REFERENCE DESIGNATIONS NOT USED			

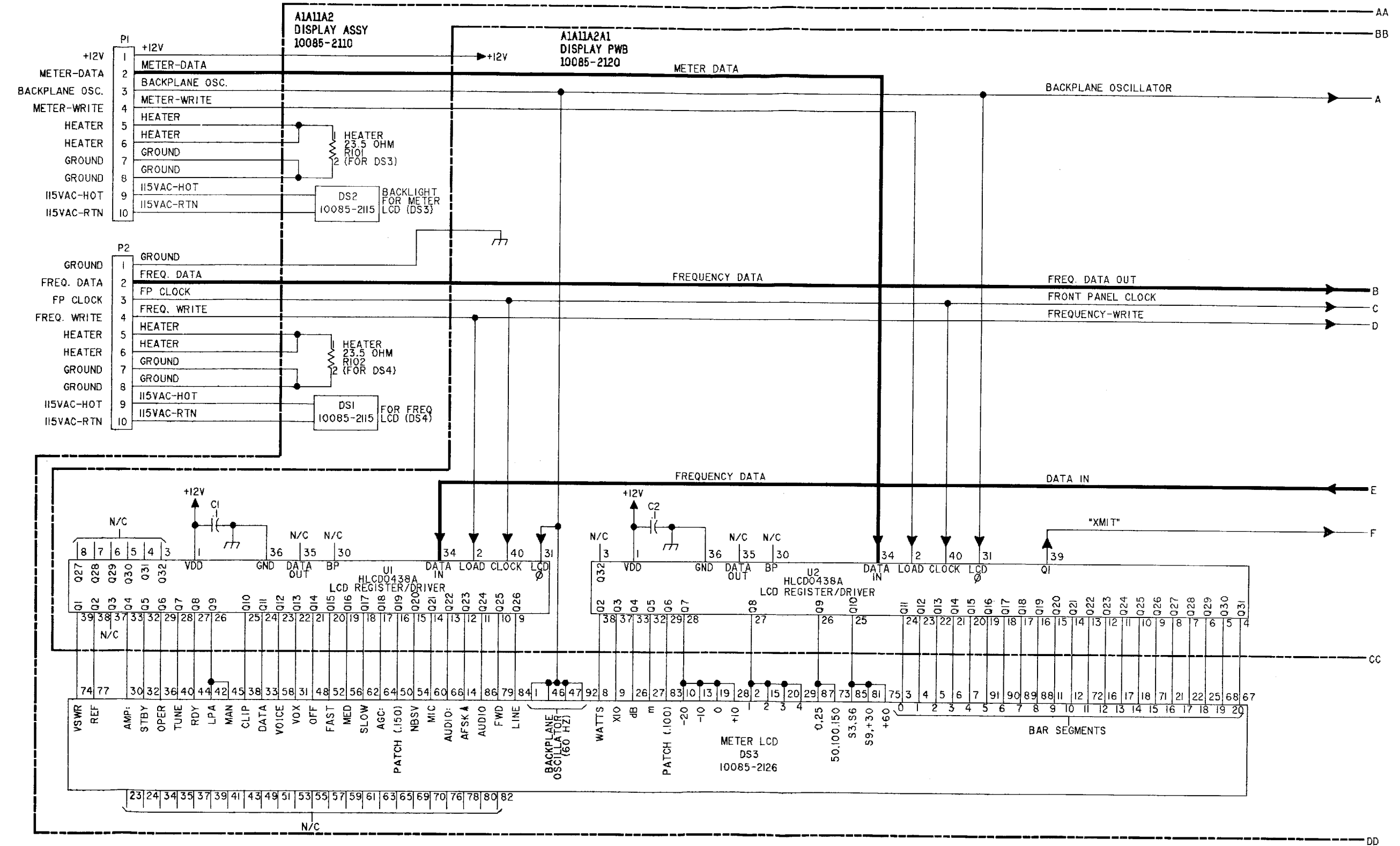

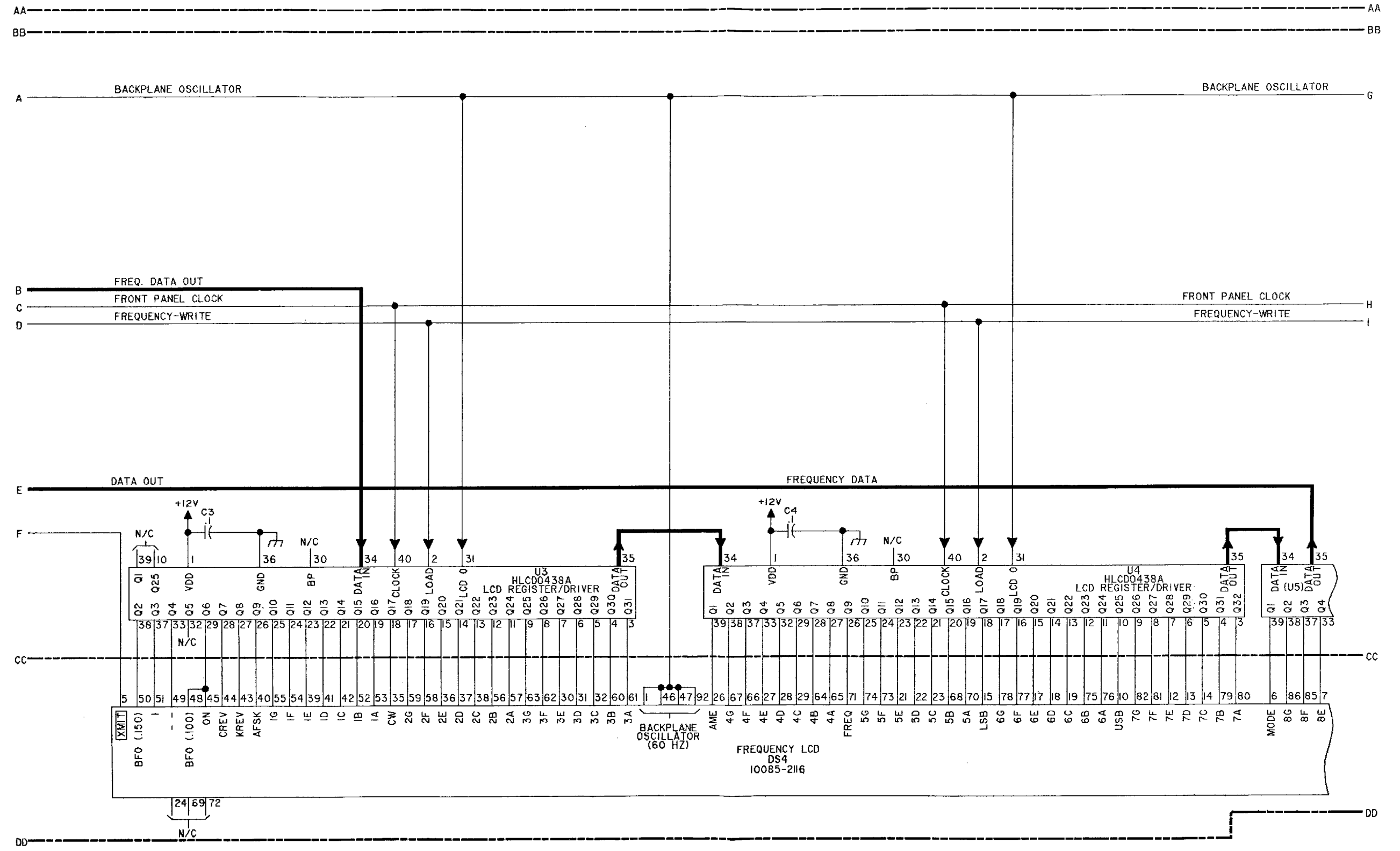

FO-5. Display Assy, A1A2 (Sheet 2 of 3)

